

REV.	DESCRIPTION	DRAWN	CHECKED	APPROVED
A	NEW RELEASE	LJC 02/07/09'	~	LJC 02/07/09'
B	整理图面	YCH 08/18/09'	~	

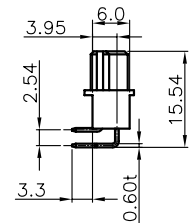
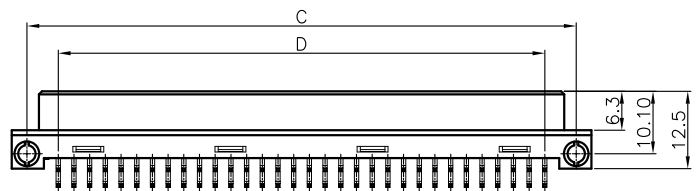
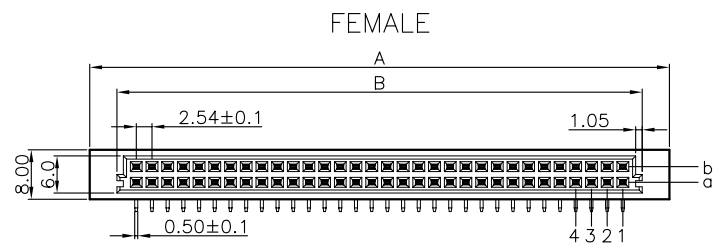
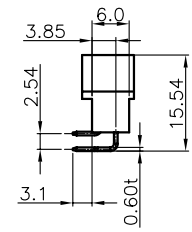
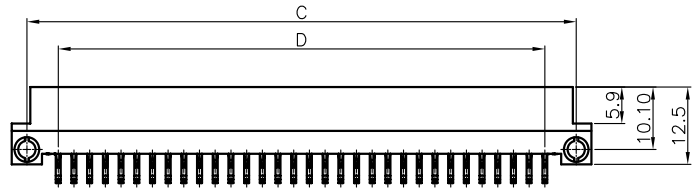
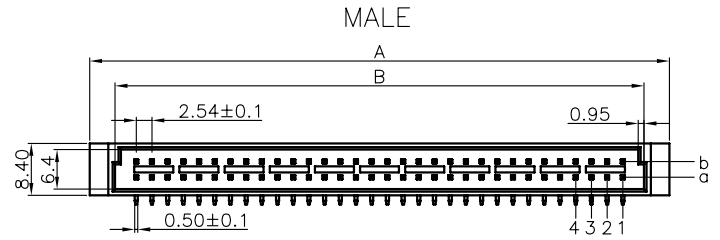

positions	A	B		C	D
		Female	Male		
64P(2*32)	93.8	85.0	85.6	88.9	78.74
32P(2*16)	53.26	44.26	44.7	48.26	38.10

NOTES:

- Specifications:
  - Contact Resistance: 20mΩ max.
  - Insulation Resistance: 1000MΩ min.
  - Current Rating: 2A.
  - Dielectric withstanding voltage: AC 1000V(r.m.s)/60s.
  - Operating Temperature: -40°C to +105°C
  - Recommend Wave Soldering Temperature: 260°C,5-10s.

2. Materials:

- Contact: Copper alloy
- Housing: Thermoplastic(UL94 V-0)

3. Product Number code:

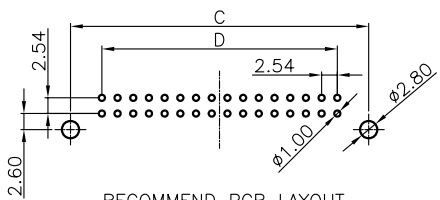
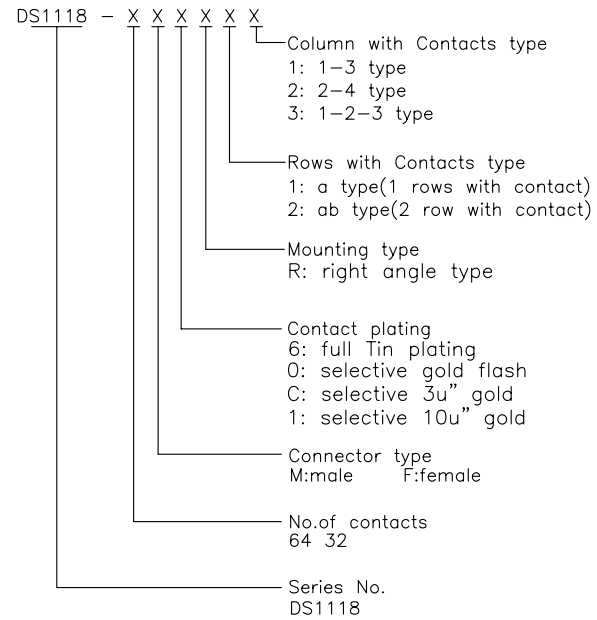

GENERAL TOLERANCE		ANGLE TOLERANCE	
X.	±0.60	X.	±5°
.X	±0.38	.X	±3°
.XX	±0.25	.XX	±2°

PROJECTION	TITLE	DIN 41612 B TYPE(2ROWS) Right Angle	
mm		SERIES	DS1118 SERIES

DRAWING TYPE	CUSTOMER		
SCALE	1:1	SHEET	1 OF 3
DRAWING NO.	C-DS1118-XXXXRXX		

 晨翔电子有限公司  
CONFLY CONFLY ELECTRONIC CO. LTD

REV.	DESCRIPTION	DRAWN	CHECKED	APPROVED
A	NEW RELEASE	LJC 02/07/09'	~	LJC 02/07/09'
B	整理图面	YCH 08/18/09'	~	

NOTES:

- Specifications:
  - Contact Resistance: 20mΩ max.
  - Insulation Resistance: 1000MΩ min.
  - Current Rating: 2A.
  - Dielectric withstanding voltage: AC 1000V(r.m.s)/60s.
  - Operating Temperature: -40°C to +105°C
  - Recommend Wave Soldering Temperature: 260°C,5-10s.

- Materials:
  - Contact: Copper alloy
  - Housing: Thermoplastic(UL94 V-0)

3. Product Number code:

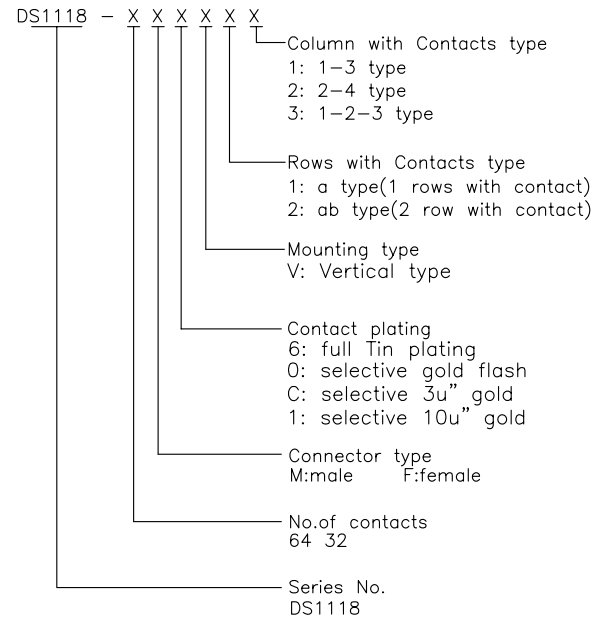

positions	A	B	C		D
			Female	Male	
64P(2*32)	94.9	90.0	85.0	85.6	78.74
32P(2*16)	54.9	50.0	44.26	44.7	38.10

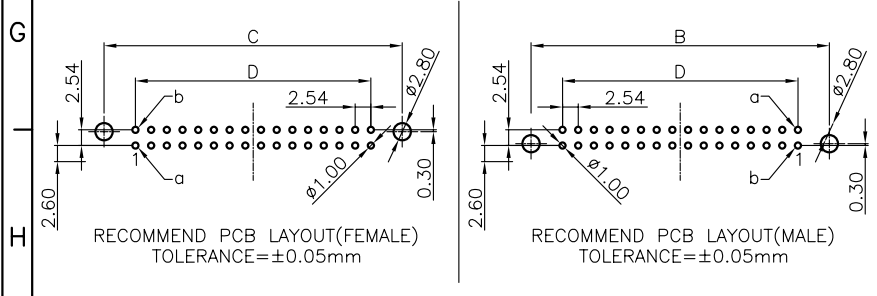
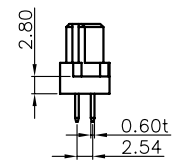
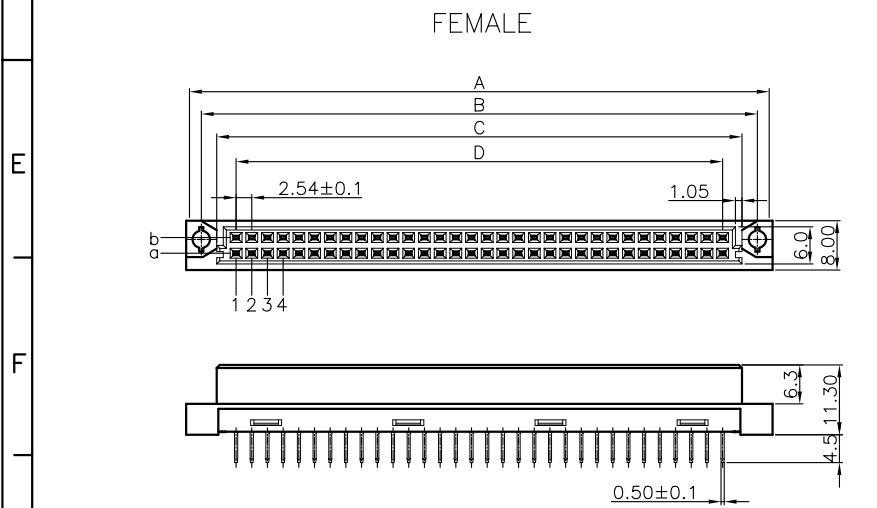
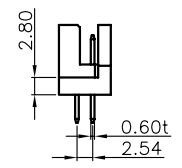
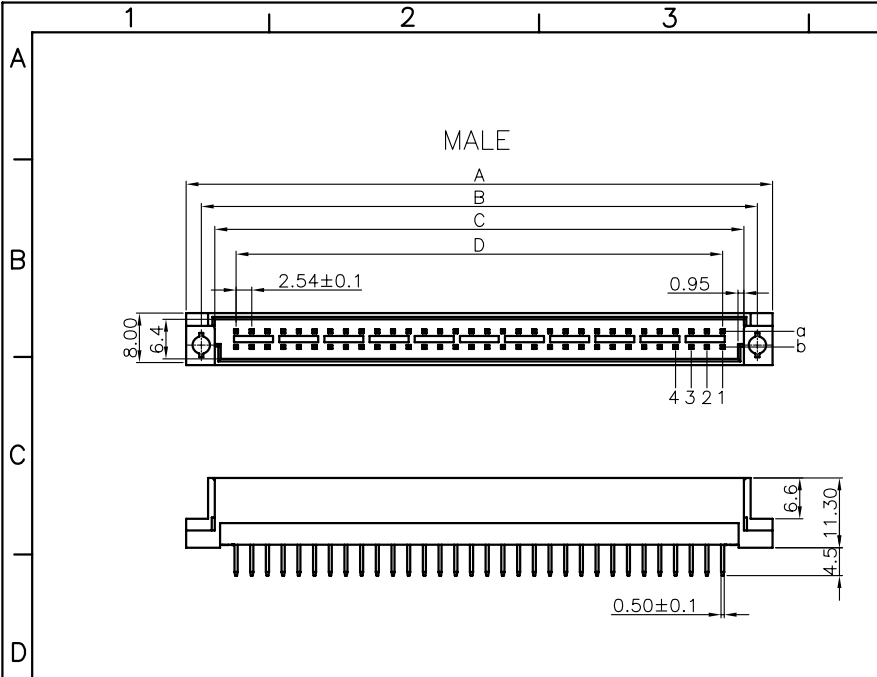

GENERAL TOLERANCE		ANGLE TOLERANCE	
X.	±0.60	X.	±5°
.X	±0.38	.X	±3°
.XX	±0.25	.XX	±2°

DRAWING TYPE	CUSTOMER		
SCALE	1:1	SHEET	2 OF 3
DRAWING NO.	C-DS1118-XXXXVXX		



PROJECTION	TITLE	DIN 41612 B TYPE(2ROWS) Vertical Through	
UNITS	mm	SHEET	A4
SHEET SIZE	A4	SERIES	DS1118 SERIES

 晨翔电子有限公司  
CONFLY CONFLY ELECTRONIC CO. LTD

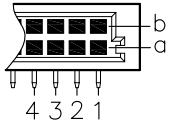
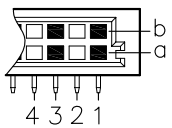
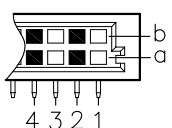
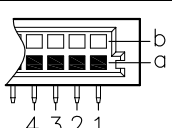
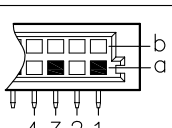
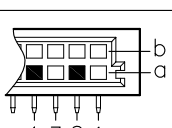
REV.	DESCRIPTION	DRAWN	CHECKED	APPROVED
A	NEW RELEASE	LJC 02/07/09'	~	LJC 02/07/09'
B	整理图面	YCH 08/18/09'	~	

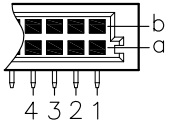
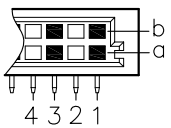
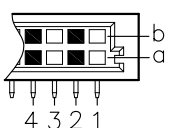
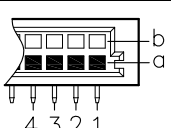
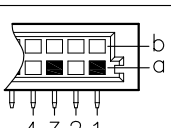
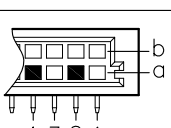
Reference to female R/A type				
Pitch	Position	Row with conctacts	column with conctacts	Contact Arrange
2.54	64 (2*32)	ab	1-2-3	
		ab	1-3	
		ab	2-4	
		a	1-2-3	
		a	1-3	
		a	2-4	

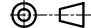
Reference to female R/A type				
Pitch	Position	Row with conctacts	column with conctacts	Contact Arrange
2.54	32 (2*16)	ab	1-2-3	
		ab	1-3	
		ab	2-4	
		a	1-2-3	
		a	1-3	
		a	2-4	

GENERAL TOLERANCE		ANGLE TOLERANCE		PROJECTION		TITLE	DIN 41612 B TYPE(2ROWS)	
X.	±0.60	X.	±5°	UNITS	mm			
.X	±0.38	.X	±3°	SHEET SIZE	A4	SERIES	DS1118	SERIES
.XX	±0.25	.XX	±2°	 <b>晨翔电子有限公司</b> <b>CONNFLY CONNFLY ELECTRONIC CO. LTD</b>				
DRAWING TYPE		CUSTOMER						
SCALE	1:1	SHEET	3 OF 3					
DRAWING NO.		C-DS1118-XXXXXXX						

REV.	DESCRIPTION	DRAWN	CHECKED	APPROVED
A	NEW RELEASE	LJC 02/02/09'	~	

MALE

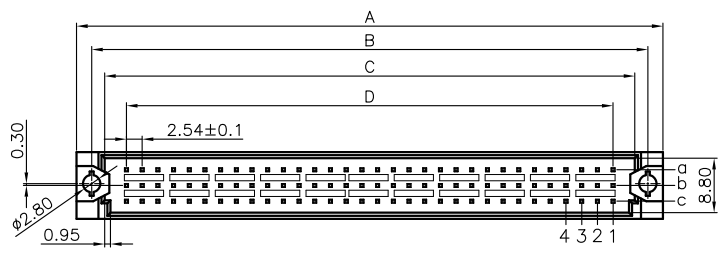

positions	A	B	C	D
96P(3*32)	94.9	90.0	85.8	78.74
48P(3*16)	54.9	50.0	44.7	38.10

NOTES:

- Specifications:
  - Contact Resistance: 20mΩ max.
  - Insulation Resistance: 1000MΩ min.
  - Current Rating: 2A.
  - Dielectric withstanding voltage: AC 1000V(r.m.s)/60s.
  - Operating Temperature: -40°C to +105°C
  - Recommend Wave Soldering Temperature: 260°C,5-10s.

FEMALE

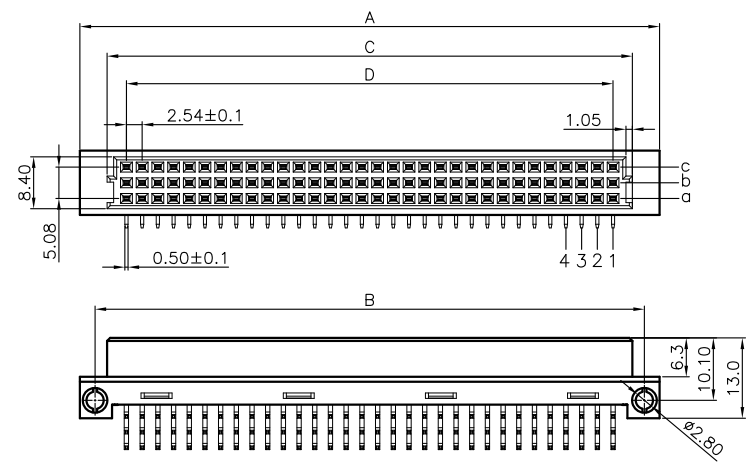

positions	A	B	C	D
96P(3*32)	93.8	88.9	85.0	78.74
48P(3*16)	53.26	48.26	44.26	38.10

2. Materials:

- Contact: Copper alloy
- Housing: PBT

3. Product Unmber code:

DS1119 - X X X X X X

- Column with Contacts type
  - 1: 1-3 type
  - 2: 2-4 type
  - 3: 1-2-3 type
- Rows with Contacts type
  - 1: abc type(3 rows with contact)
  - 2: ac type(2 rows with contact)
  - 3: a type(1 rows with contact)
- Mounting type
  - R: right angle type
  - V: V/T type
- Contact plating
  - 6: full Tin plating
  - 0: selective gold flash
- Connector type
  - M: male
  - F: female
- No.of contacts
  - 96 (3\*32)
  - 48 (3\*16)

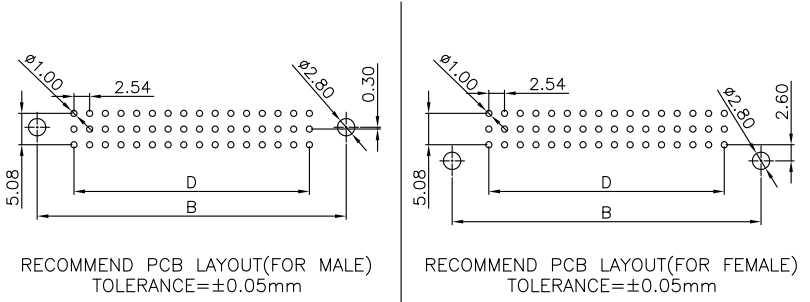
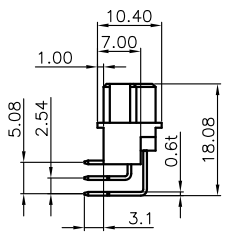
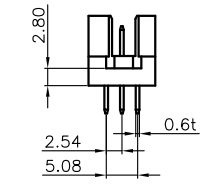

GENERAL TOLERANCE	ANGLE TOLERANCE
X. ±0.60	X. ±5°
.X ±0.38	.X ±3°
.XX ±0.25	.XX ±2°

PROJECTION	TITLE
	DIN 41612 C TYPE (3ROWS)
UNITS	mm
SHEET SIZE	A4
SERIES	DS1119 SERIES

DRAWING TYPE	CUSTOMER
SCALE	1:1 SHEET 1 OF 2
DRAWING NO.	C-DS1119-XXXXXXX

晨翔电子有限公司  
**CONNFLY CONNFLY ELECTRONIC CO. LTD**

REV.	DESCRIPTION	DRAWN	CHECKED	APPROVED
A	NEW RELEASE	LJC 02/02/09'	~	

Reference to female R/A type				
Pitch	Position	Row with contacts	column with contacts	Contact Arrange
2.54	96 (3*32)	abc	1-2-3	
		abc	1-3	
		abc	2-4	
		ac	1-2-3	
		ac	1-3	
		ac	2-4	
		a	1-2-3	
		a	1-3	
		a	2-4	

Reference to female R/A type				
Pitch	Position	Row with contacts	column with contacts	Contact Arrange
2.54	48 (3*16)	abc	1-2-3	
		abc	1-3	
		abc	2-4	
		ac	1-2-3	
		ac	1-3	
		ac	2-4	
		a	1-2-3	
		a	1-3	
		a	2-4	

GENERAL TOLERANCE		ANGLE TOLERANCE		PROJECTION		TITLE	DIN 41612 C TYPE (3ROWS)	
X.	±0.60	X.	±5'	UNITS	mm	SHEET SIZE	A4	SERIES DS1119 SERIES
.X	±0.38	.X	±3'	晨翔电子有限公司 <b>CONNFLY CONNFLY ELECTRONIC CO. LTD</b>				
.XX	±0.25	.XX	±2'					
DRAWING TYPE		CUSTOMER						
SCALE		1:1	SHEET	2 OF 2				
DRAWING NO.		C-DS1119-XXXXXXX						

REV.	DESCRIPTION	DRAWN	CHECKED	APPROVED
A	NEW RELEASE	LJC 02/02/09'	~	LJC 02/02/09'

FEMALE

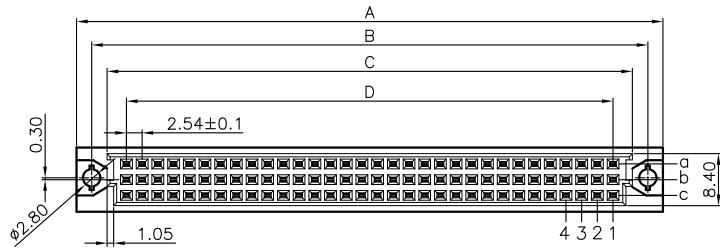

positions	A	B	C	D
96P(3*32)	94.9	90.0	85.0	78.74
48P(3*16)	54.9	50.0	44.26	38.10

NOTES:

- Specifications:
  - Contact Resistance: 20mΩ max.
  - Insulation Resistance: 1000MΩ min.
  - Current Rating: 2A.
  - Dielectric withstanding voltage: AC 1000V(r.m.s)/60s.
  - Operating Temperature: -40°C to +105°C
  - Recommend Wave Soldering Temperature: 260°C,5-10s.

- Materials:
  - Contact: Copper alloy
  - Housing: PBT

3. Product Unmber code:

DS1120 - X X X X X X

- Column with Contacts type
  - 1: 1-3 type
  - 2: 2-4 type
  - 3: 1-2-3 type
- Rows with Contacts type
  - 1: abc type(3 rows with contact)
  - 2: ac type(2 rows with contact)
  - 3: a type(1 rows with contact)
- Mounting type
  - R: right angle type
  - V: V/T type
- Contact plating
  - 6: full Tin plating
  - 0: selective gold flash
- Connector type
  - M:male
  - F:female
- No.of contacts
  - 96 (3\*32)
  - 48 (3\*16)

MALE

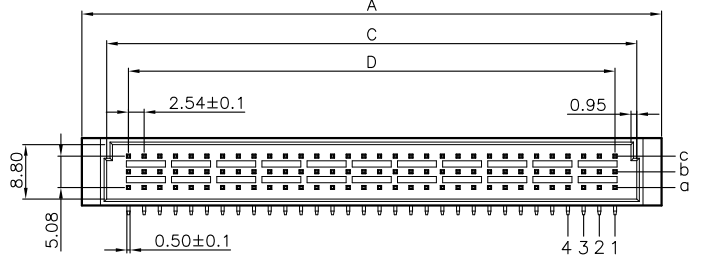

positions	A	B	C	D
96P(3*32)	93.8	88.9	85.8	78.74
48P(3*16)	53.26	48.26	44.7	38.10

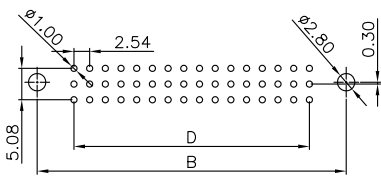
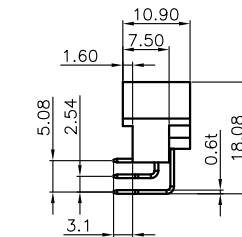
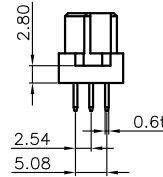

RECOMMEND PCB LAYOUT(FOR FEMALE)  
TOLERANCE=±0.05mm

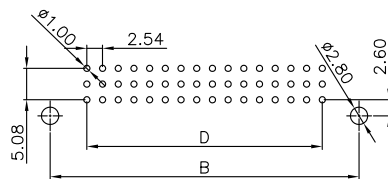

RECOMMEND PCB LAYOUT(FOR MALE)  
TOLERANCE=±0.05mm

GENERAL TOLERANCE		ANGLE TOLERANCE	
X.	±0.60	X.	±5°
.X	±0.38	.X	±3°
.XX	±0.25	.XX	±2°

DRAWING TYPE	CUSTOMER	
SCALE	1:1	SHEET 1 OF 2
DRAWING NO.	C-DS1120-XXXXXXX	

PROJECTION	TITLE
UNITS	DIN 41612 C & RTYPE (3ROWS)
SHEET SIZE	SERIES DS1120 SERIES

**晨翔电子有限公司**  
**CONNFLY CONNFLY ELECTRONIC CO. LTD**

REV.	DESCRIPTION	DRAWN	CHECKED	APPROVED
A	NEW RELEASE	LJC 02/02/09'	~	LJC 02/02/09'

Reference to female R/A type				
Pitch	Position	Row with conntacts	column with conntacts	Contact Arrange
2.54	96 (3*32)	abc	1-2-3	
		abc	1-3	
		abc	2-4	
		ac	1-2-3	
		ac	1-3	
		ac	2-4	
		a	1-2-3	
		a	1-3	
		a	2-4	

Reference to female R/A type				
Pitch	Position	Row with conntacts	column with conntacts	Contact Arrange
2.54	48 (3*16)	abc	1-2-3	
		abc	1-3	
		abc	2-4	
		ac	1-2-3	
		ac	1-3	
		ac	2-4	
		a	1-2-3	
		a	1-3	
		a	2-4	

GENERAL TOLERANCE		ANGLE TOLERANCE		PROJECTION		TITLE	DIN 41612 C & RTYPE (3ROWS)		
X.	±0.60	X.	±5'	UNITS	mm	SHEET SIZE	A4		
.X	±0.38	.X	±3'	SHEET SIZE	A4	SERIES	DS1120 SERIES		
.XX	±0.25	.XX	±2'	<b>晨翔电子有限公司</b> <b>CONNFLY CONNFLY ELECTRONIC CO. LTD</b>					
DRAWING TYPE		CUSTOMER							
SCALE	1:1	SHEET	2 OF 2						
DRAWING NO.		C-DS1120-XXXXXXX							