

REV.	DESCRIPTION	DRAWN	CHECKED	APPROVED
A	NEW RELEASE	YCH 03/24/09	~	

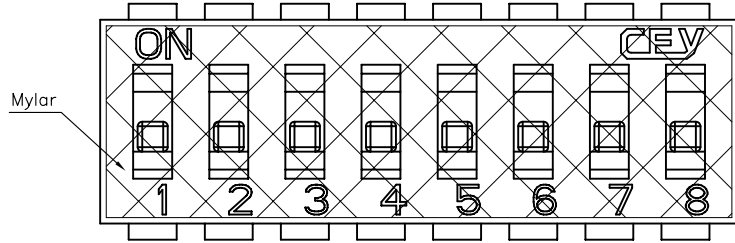

Specification:

1. Contact resistance: 100mΩ max.
2. Dielectric withstanding voltage: 250 VAC 1minute.
3. Insulation resistance: 1000 MΩ min.
4. Temperature range: -40°C ~ +105°C.
5. Operating Life: 2000 cycle min.

Material:

1. Insulator: high temperature 260°C, UL 94V-0.
2. Contact: copper alloy.

Product number code:

DS1040-02 - X X X X X

Packing type
B: tube
T: tray
R: tape & reel

Actuator color
W: White
Housing color
B: Black

Mounting type
V: V/T type
S: SMT type

No. of contacts
2 3 4 5 6 7
8 9 10 11 12

V/T type

SMT type

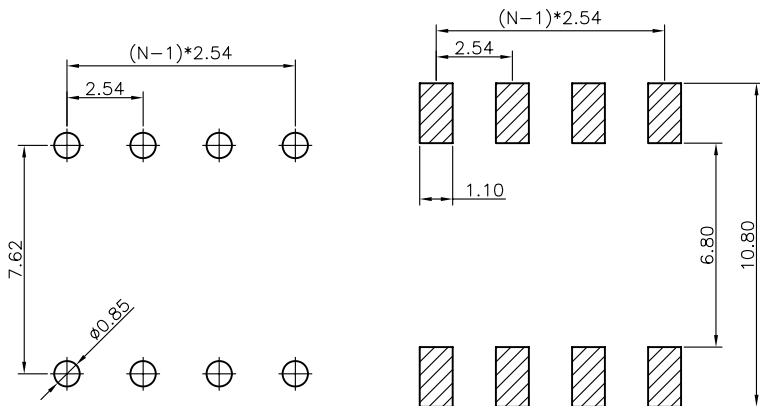
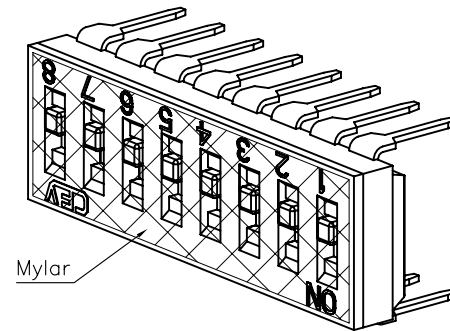
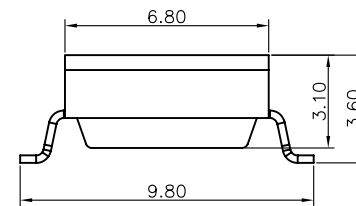
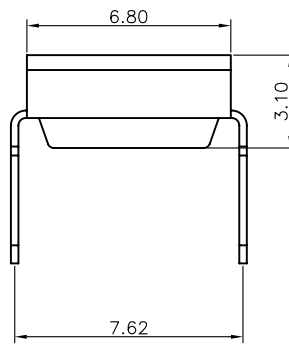
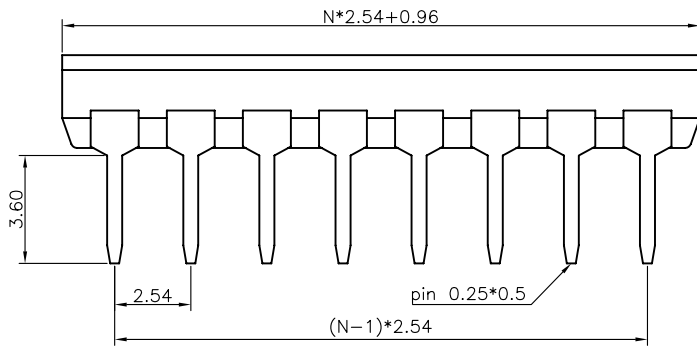

RECOMMEND PCB LAYOUT
(TOLERANCE=±0.05)

GENERAL TOLERANCE		ANGLE TOLERANCE		PROJECTION		TITLE	SWITCH PITCH 2.54mm SMT WITH MYLAR TYPE	
X.	±0.60	X.	±5°	UNITS	mm			
.X	±0.38	.X	±3°	SHEET SIZE	A4	SERIES	DS1040-02	
.XX	±0.25	.XX	±2°	晨翔电子有限公司 CONNFLY CONNFLY ELECTRONIC CO. LTD				
DRAWING TYPE		CUSTOMER						
SCALE	1:1	SHEET	1 OF 1					
DRAWING NO.		C-DS1040-02-XXXXX						