

REV.	DESCRIPTION	DRAWN	CHECKED	APPROVED
A	NEW RELEASE	LL 05/05/06'		

NOTES:

1.Materials

1.1. Insulator: thermoplastic

2.Specifications

2.1. Temperature range: -20~+80°C.

2.2. Contact resistance: 100mΩ max.

2.3. Insulation resistance: 1000MΩ min.

2.4. Dielectric withstanding voltage: AC 500V  
Per minute.

3.Product number code:

DS1136-01 - X X X X

- X: Housing color  
W:white
- X: Contact plating  
N:full nickel
- X: Connector type  
S:socket
- X: No. of contacts  
270 Position
- SERIES No.  
DS1136-01

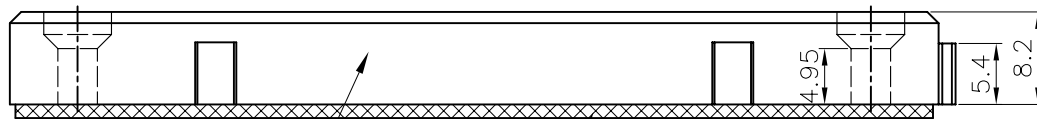
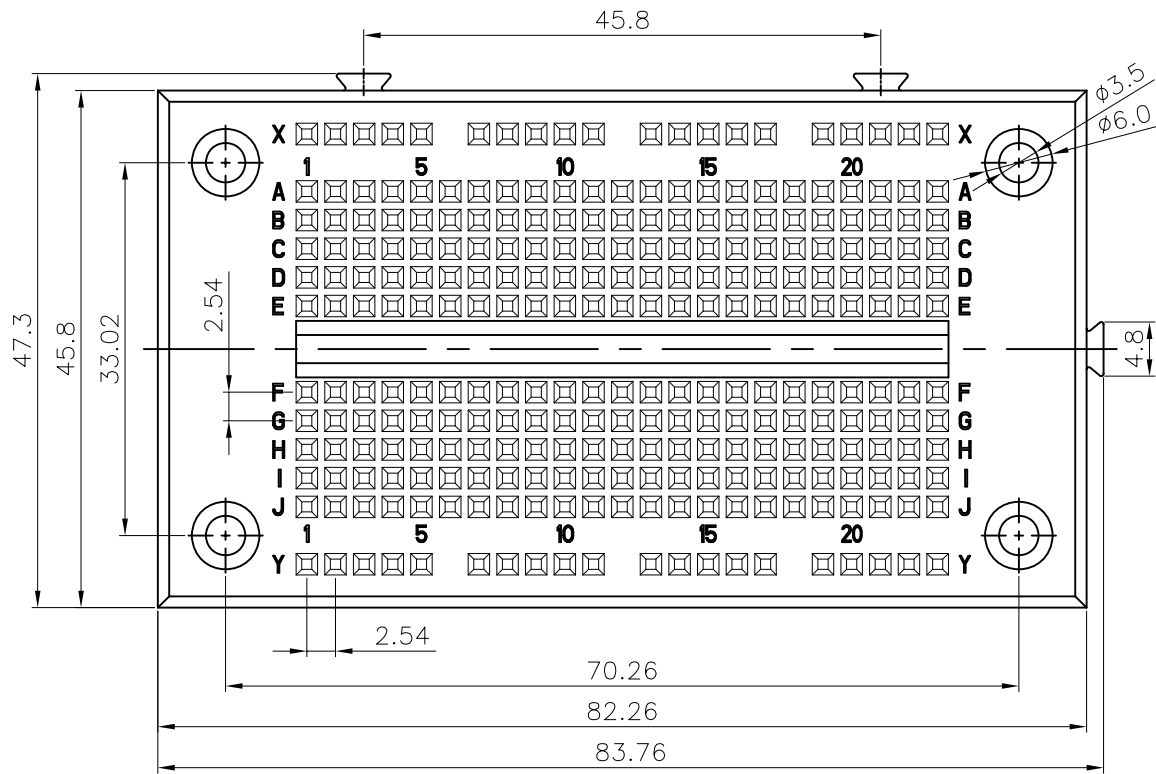

Insulator  
Adhesive tape

GENERAL TOLERANCE		ANGLE TOLERANCE	
X.	±0.60	X.	±5°
.X	±0.38	.X	±3°
.XX	±0.25	.XX	±2°

DRAWING TYPE	CUSTOMER		
SCALE	1:1	SHEET	1 OF 1
DRAWING NO.	C-DS1136-01-XXXX		

PROJECTION	TITLE
UNITS	Bread Board pitch 2.54mm
SHEET SIZE	SERIES DS1136-01 SERIES

 晨翔电子有限公司  
**CONNFLY CONNFLY ELECTRONIC CO. LTD**

REV.	DESCRIPTION	DRAWN	CHECKED	APPROVED
A	NEW RELEASE	LL 05/05/06'		

NOTES:

1. Materials
  - 1.1. Insulator: thermoplastic
2. Specifications
  - 2.1. Temperature range: -20~+80°C.
  - 2.2. Contact resistance: 100mΩ max.
  - 2.3. Insulation resistance: 1000MΩ min.
  - 2.4. Dielectric withstanding voltage: AC 500V Per minute.
3. Product number code:

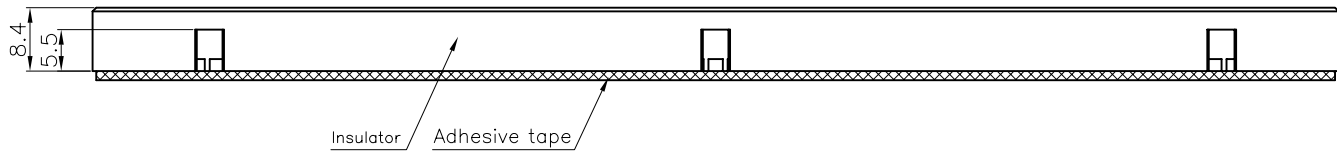
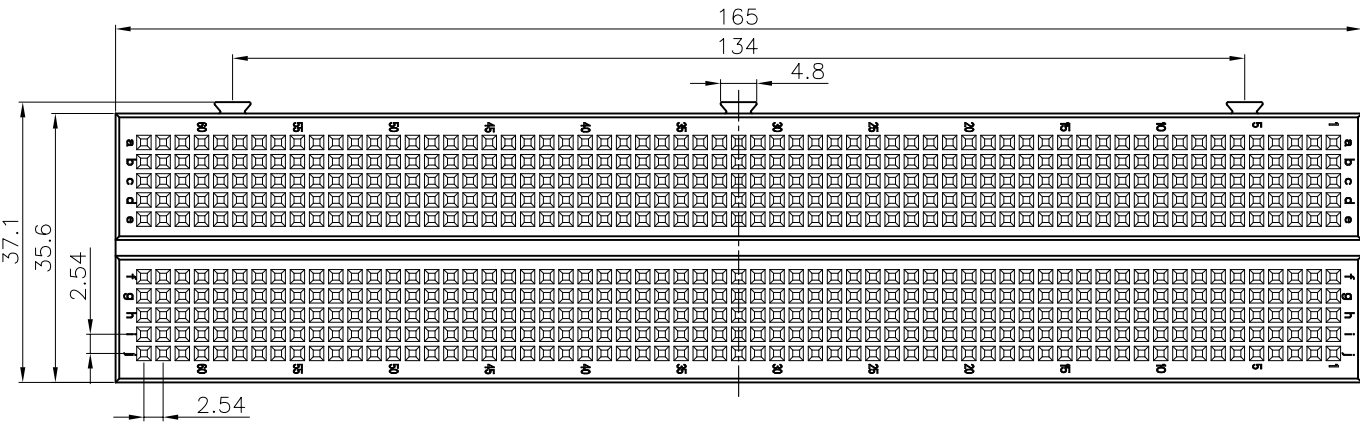
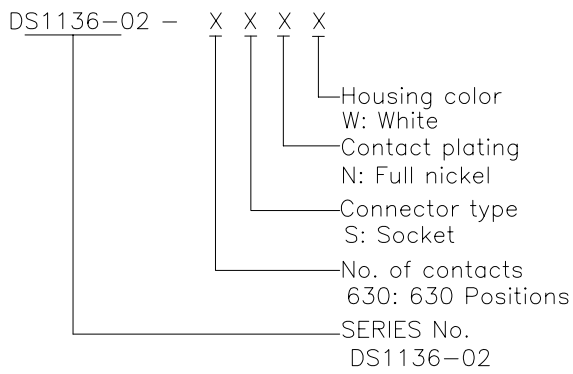

GENERAL TOLERANCE		ANGLE TOLERANCE		PROJECTION		TITLE	
X.	±0.60	X.	±5°	UNITS	mm	Bread Board pitch 2.54mm	
.X	±0.38	.X	±3°	SHEET SIZE	A4	SERIES	DS1136-02 SERIES
.XX	±0.25	.XX	±2°	<b>晨翔电子有限公司</b> <b>CONNFLY CONNFLY ELECTRONIC CO. LTD</b>			
DRAWING TYPE		CUSTOMER					
SCALE		1:1	SHEET 1 OF 1				
DRAWING NO.		C-DS1136-02-XXXX					

REV.	DESCRIPTION	DRAWN	CHECKED	APPROVED
A	NEW RELEASE	LL 05/05/06'		

NOTES:

1. Materials
  - 1.1. Insulator: thermoplastic
2. Specifications
  - 2.1. Temperature range: -20~+80°C.
  - 2.2. Contact resistance: 100mΩ max.
  - 2.3. Insulation resistance: 1000MΩ min.
  - 2.4. Dielectric withstanding voltage: AC 500V Per minute.
3. Product number code:

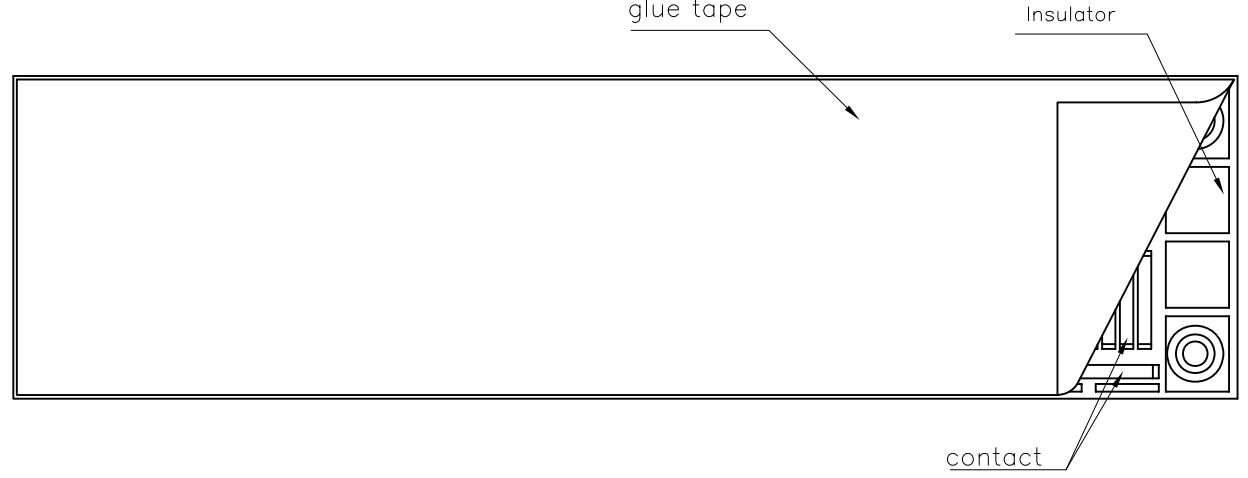
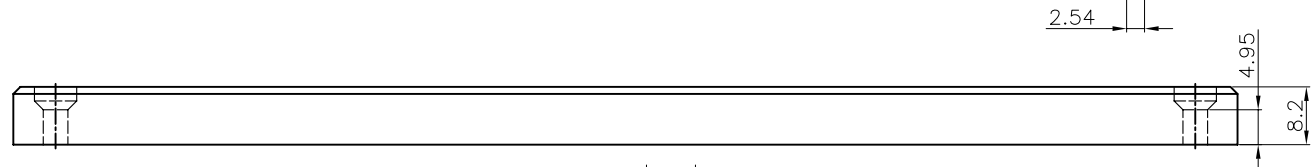
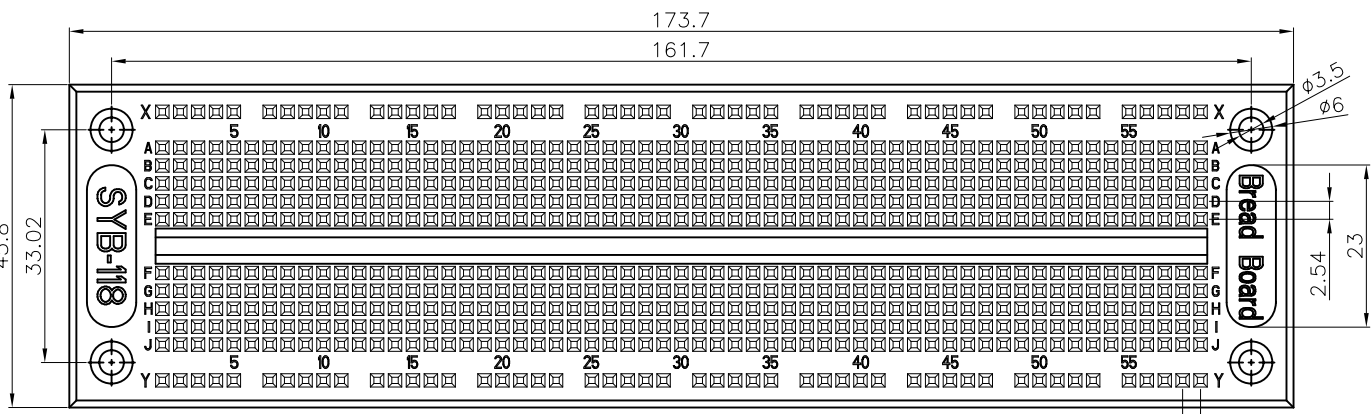
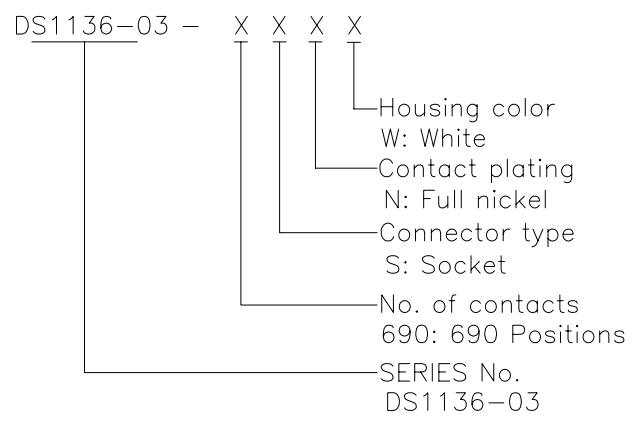

GENERAL TOLERANCE		ANGLE TOLERANCE		PROJECTION		TITLE	Bread Board pitch 2.54mm	
X.	±0.60	X.	±5°	UNITS	mm			
.X	±0.38	.X	±3°	SHEET SIZE	A4	SERIES	DS1136-03 SERIES	
.XX	±0.25	.XX	±2°	<b>晨翔电子有限公司</b> <b>CONNFLY ELECTRONIC CO. LTD</b>				
DRAWING TYPE		CUSTOMER						
SCALE		1:1	SHEET 1 OF 1					
DRAWING NO.		C-DS1136-03-XXXX						

REV.	DESCRIPTION	DRAWN	CHECKED	APPROVED
A	NEW RELEASE	LL 05/05/06'		

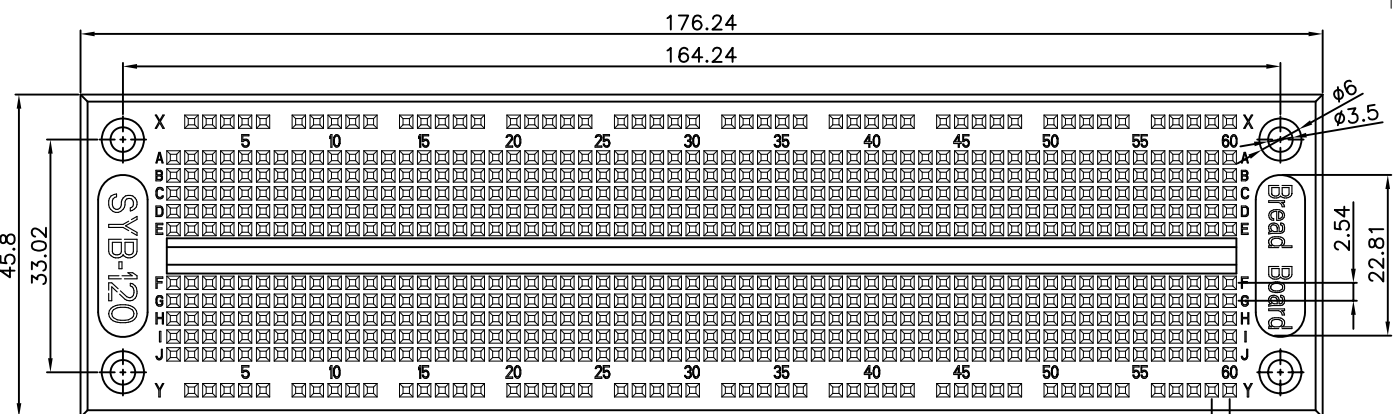

NOTES:

1. Materials
  - 1.1. Insulator: thermoplastic
2. Specifications
  - 2.1. Temperature range:  $-20\sim+80^{\circ}\text{C}$ .
  - 2.2. Contact resistance:  $100\text{m}\Omega$  max.
  - 2.3. Insulation resistance:  $1000\text{M}\Omega$  min.
  - 2.4. Dielectric withstanding voltage: AC 500V Per minute.
3. Product number code:

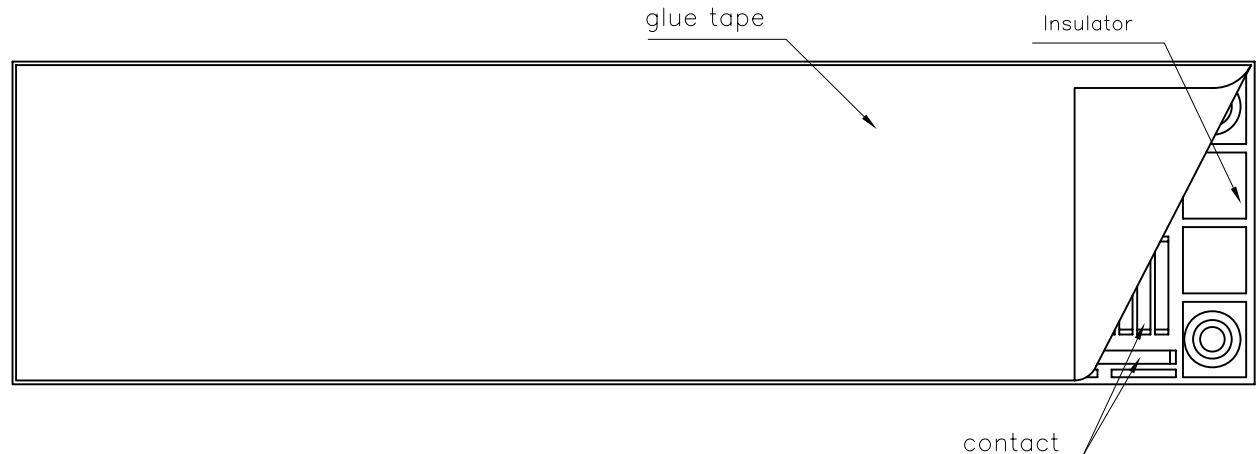
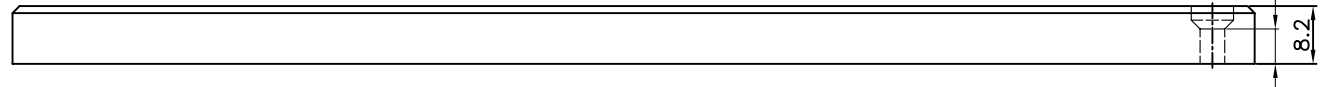
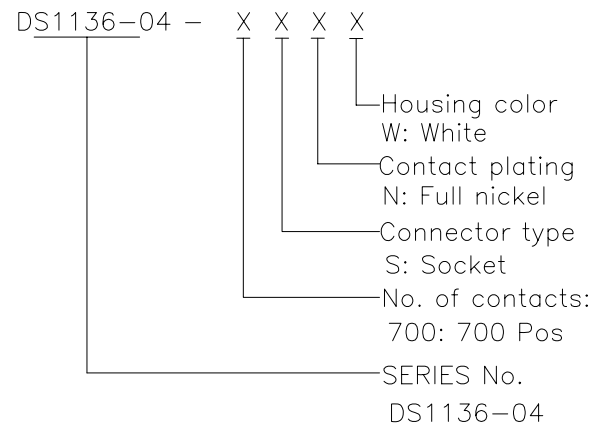

GENERAL TOLERANCE		ANGLE TOLERANCE		PROJECTION		TITLE	Bread Board pitch 2.54mm	
X.	$\pm 0.60$	X.	$\pm 5^{\circ}$	UNITS	mm			
.X	$\pm 0.38$	.X	$\pm 3^{\circ}$	SHEET SIZE	A4	SERIES	DS1136-04	SERIES
.XX	$\pm 0.25$	.XX	$\pm 2^{\circ}$	<b>晨翔电子有限公司</b> <b>CONNFLY CONNFLY ELECTRONIC CO. LTD</b>				
DRAWING TYPE		CUSTOMER						
SCALE		1:1	SHEET 1 OF 1					
DRAWING NO.		C-DS1136-04-XXXX						

REV.	DESCRIPTION	DRAWN	CHECKED	APPROVED
A	NEW RELEASE	LL 05/05/06'		

NOTES:

1.Materials

1.1. Insulator: thermoplastic

2.Specifications

2.1. Temperature range: -20~+80°C.

2.2. Contact resistance: 100mΩ max.

2.3. Insulation resistance: 1000MΩ min.

2.4. Dielectric withstanding voltage: AC 500V  
Per minute.

3.Product number code:

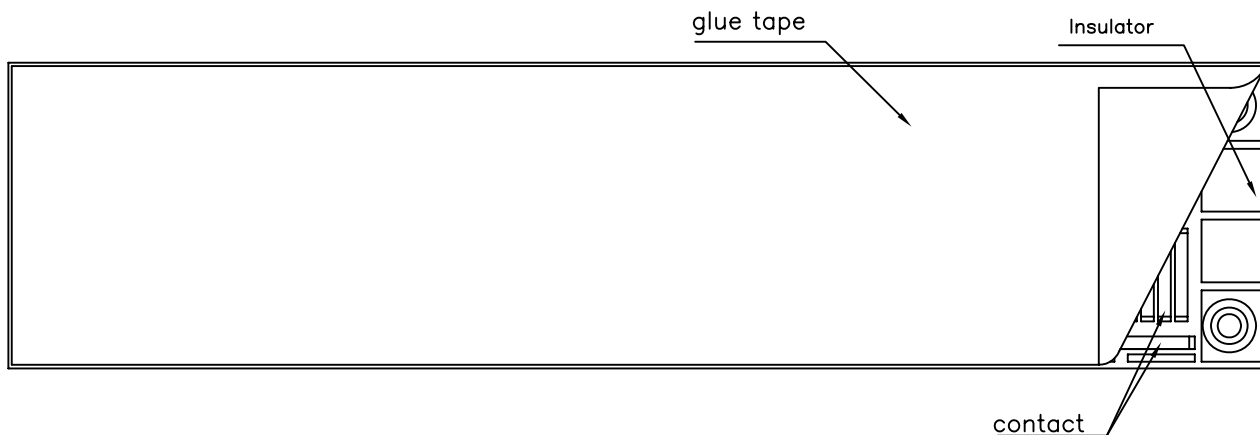
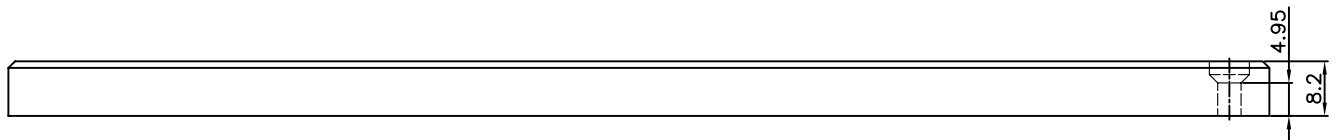
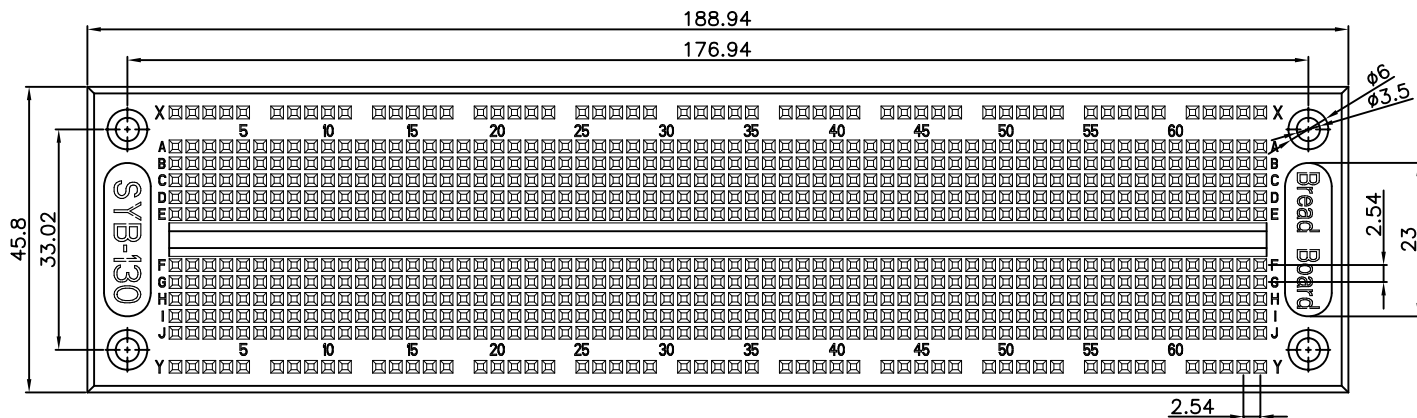
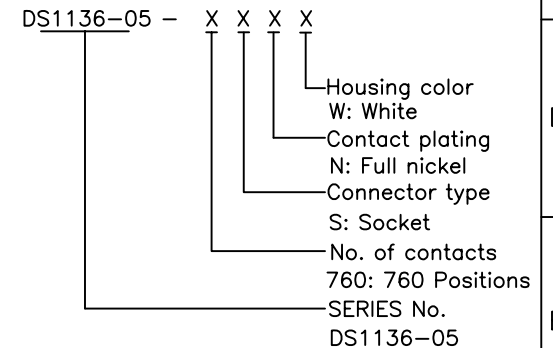

GENERAL TOLERANCE		ANGLE TOLERANCE		PROJECTION		TITLE	Bread Board pitch 2.54mm	
X.	±0.60	X.	±5°	UNITS	mm			
.X	±0.38	.X	±3°	SHEET SIZE	A4	SERIES	DS1136-05 SERIES	
.XX	±0.25	.XX	±2°			<b>晨翔电子有限公司</b> <b>CONNFLY CONNFLY ELECTRONIC CO. LTD</b>		
DRAWING TYPE		CUSTOMER						
SCALE		1:1	SHEET	1 OF 1				
DRAWING NO.		C-DS1136-05-XXXX						

REV.	DESCRIPTION	DRAWN	CHECKED	APPROVED
A	NEW RELEASE	LL 05/05/06'		

NOTES:

1. Materials
  - 1.1. Insulator: thermoplastic
2. Specifications
  - 2.1. Temperature range:  $-20\sim+80^{\circ}\text{C}$ .
  - 2.2. Contact resistance:  $100\text{m}\Omega$  max.
  - 2.3. Insulation resistance:  $1000\text{M}\Omega$  min.
  - 2.4. Dielectric withstanding voltage: AC 500V  
Per minute.
3. Product number code:

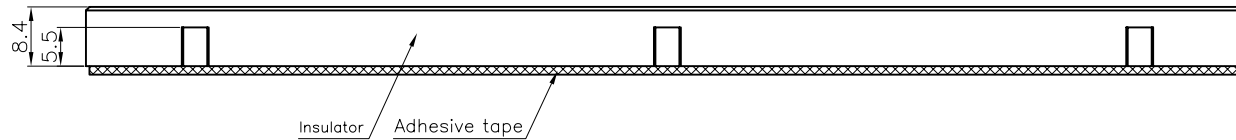
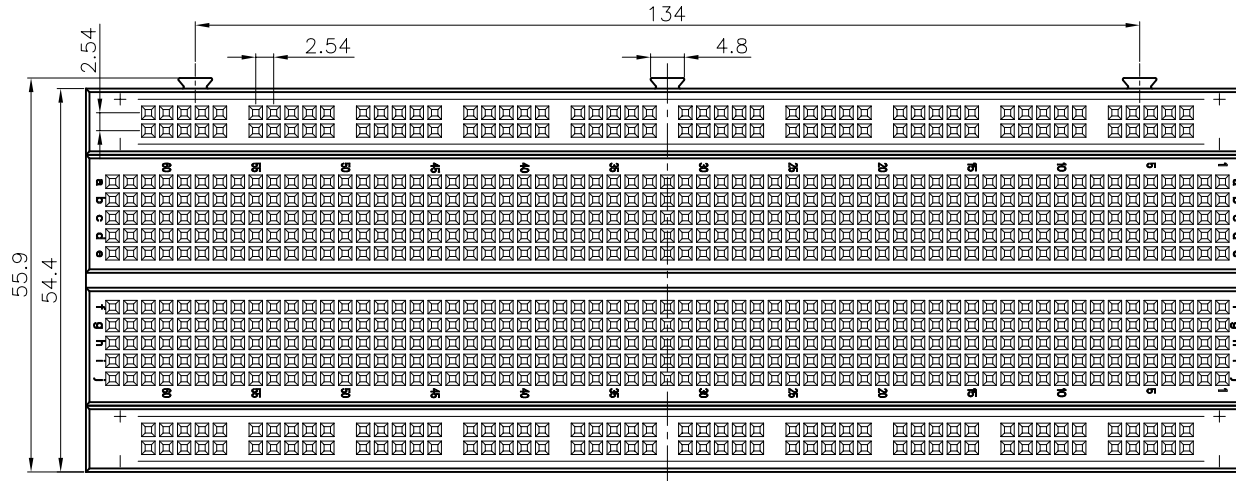
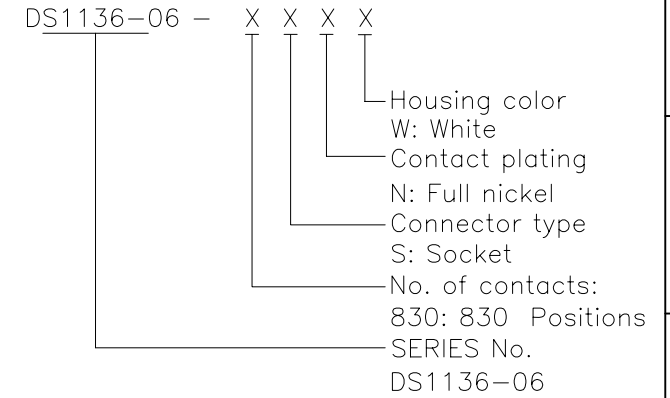

GENERAL TOLERANCE		ANGLE TOLERANCE		PROJECTION		TITLE	Bread Board pitch 2.54mm	
X.	$\pm 0.60$	X.	$\pm 5^{\circ}$	UNITS	mm			
.X	$\pm 0.38$	.X	$\pm 3^{\circ}$	SHEET SIZE	A4	SERIES	DS1136-06 SERIES	
.XX	$\pm 0.25$	.XX	$\pm 2^{\circ}$	<b>晨翔电子有限公司</b> <b>CONNFLY CONNFLY ELECTRONIC CO. LTD</b>				
DRAWING TYPE		CUSTOMER						
SCALE		1:1	SHEET 1 OF 1					
DRAWING NO.		C-DS1136-06-XXXX						

REV.	DESCRIPTION	DRAWN	CHECKED	APPROVED
A	NEW RELEASE	LL 05/05/06'		

NOTES:

1. Materials
  - 1.1. Insulator: thermoplastic
2. Specifications
  - 2.1. Temperature range: -20~+80°C.
  - 2.2. Contact resistance: 100mΩ max.
  - 2.3. Insulation resistance: 1000MΩ min.
  - 2.4. Dielectric withstanding voltage: AC 500V Per minute.

3. Product number code:

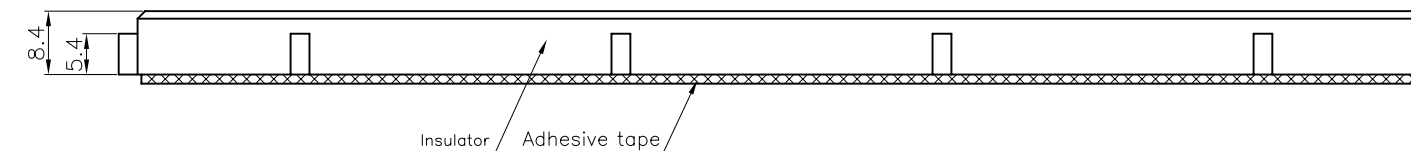
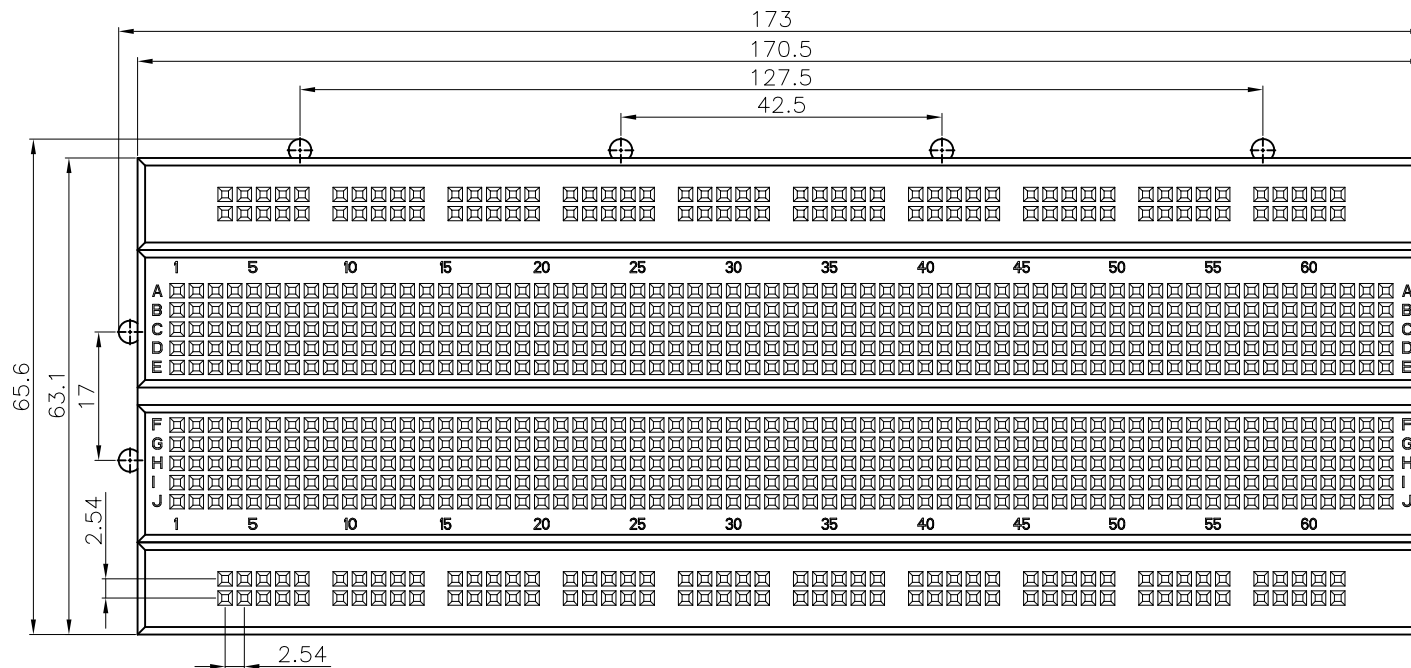
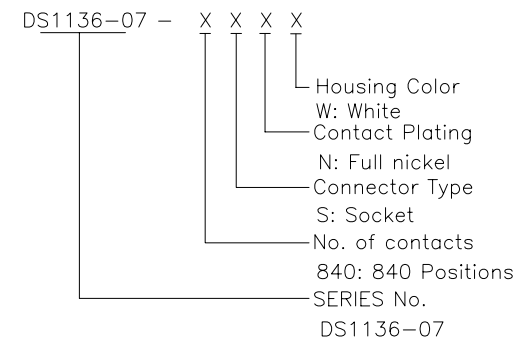

GENERAL TOLERANCE		ANGLE TOLERANCE		PROJECTION		TITLE	Bread Board Pitch 2.54mm	
X.	±0.60	X.	±5°	UNITS	mm			
.X	±0.38	.X	±3°	SHEET SIZE	A4	SERIES	DS1136-07	SERIES
.XX	±0.25	.XX	±2°	<b>晨翔电子有限公司</b> <b>CONNFLY CONNFLY ELECTRONIC CO. LTD</b>				
DRAWING TYPE		CUSTOMER						
SCALE		1:1	SHEET 1 OF 1					
DRAWING NO.		C-DS1136-07-XXXX						

REV.	DESCRIPTION	DRAWN	CHECKED	APPROVED
A	NEW RELEASE	LJH 05/06/06'		

NOTES:

1. Materials
  - 1.1. Insulator: thermoplastic
2. Specifications
  - 2.1. Temperature range:  $-20\sim+80^{\circ}\text{C}$ .
  - 2.2. Contact resistance: 100m $\Omega$  max.
  - 2.3. Insulation resistance: 1000M $\Omega$  min.
  - 2.4. Dielectric withstanding voltage: AC 500V Per minute.
3. Product number code:

DS1136-08 - X X X X

- X: Housing color  
W: White
- X: Contact plating  
N: Full nickel
- X: Connector type  
S: Socket
- X: No. of contacts:  
1360:1360 Pos

SERIES No.  
DS1136-08

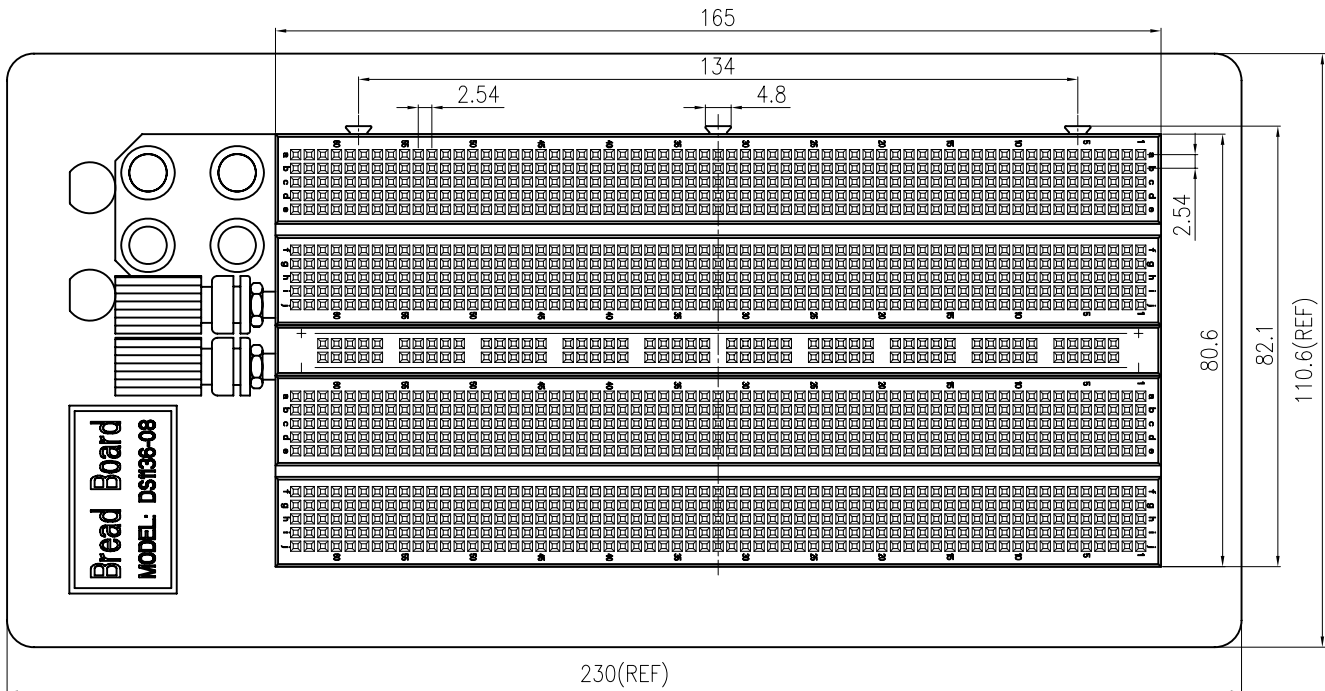

GENERAL TOLERANCE		ANGLE TOLERANCE		PROJECTION		TITLE	Bread Board pitch 2.54mm	
X.	$\pm 0.60$	X.	$\pm 5^{\circ}$	UNITS	mm			
.X	$\pm 0.38$	.X	$\pm 3^{\circ}$	SHEET SIZE	A4	SERIES	DS1136-08	SERIES
.XX	$\pm 0.25$	.XX	$\pm 2^{\circ}$	<b>晨翔电子有限公司</b> <b>CONNFLY CONNFLY ELECTRONIC CO. LTD</b>				
DRAWING TYPE		CUSTOMER						
SCALE		1:1 SHEET 1 OF 1						
DRAWING NO.		C-DS1136-08-XXXX						



REV.	DESCRIPTION	DRAWN	CHECKED	APPROVED
A	NEW RELEASE	LL 06/06/06'		

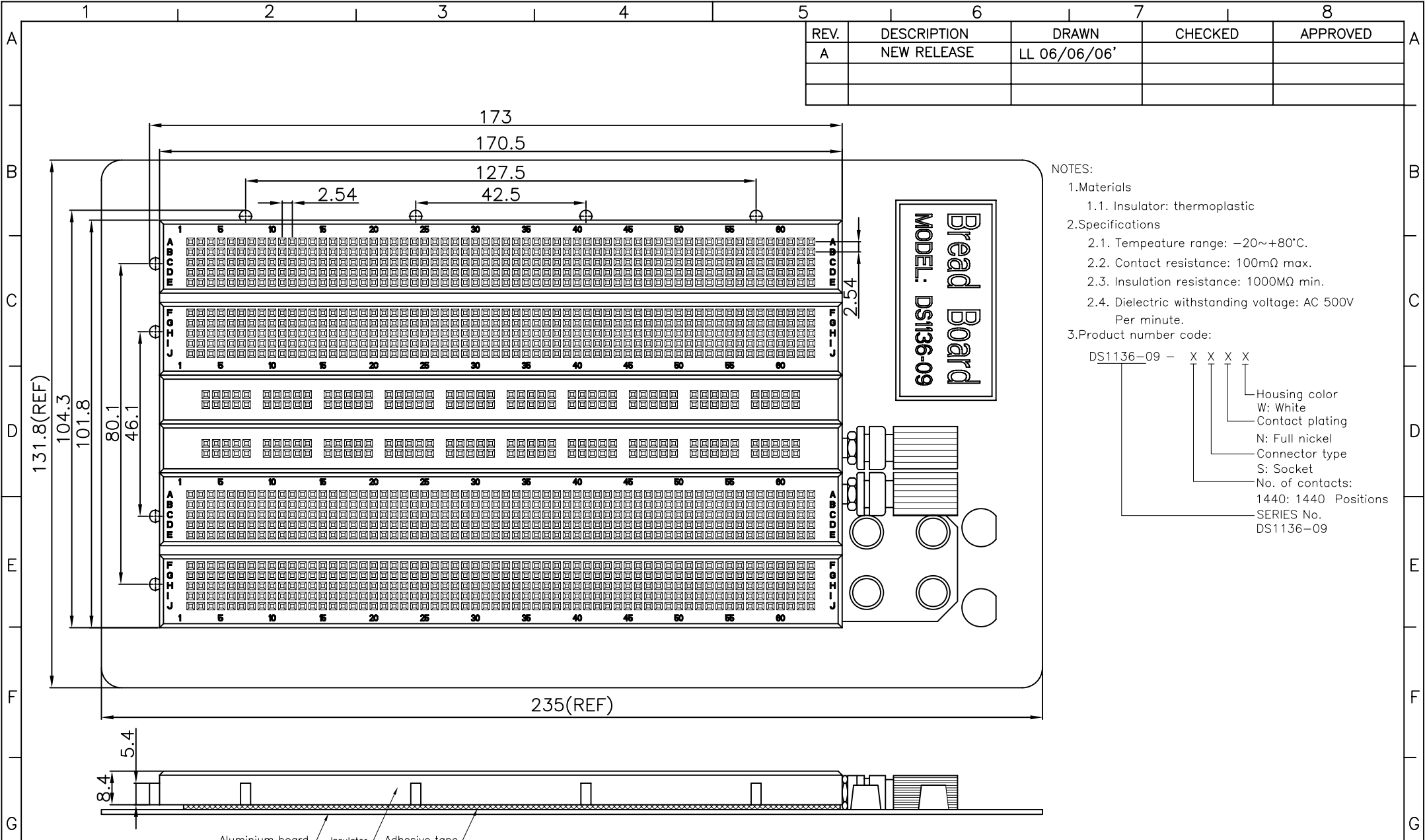

- NOTES:
- Materials
    - 1.1. Insulator: thermoplastic
  - Specifications
    - 2.1. Temperature range: -20~+80°C.
    - 2.2. Contact resistance: 100mΩ max.
    - 2.3. Insulation resistance: 1000MΩ min.
    - 2.4. Dielectric withstanding voltage: AC 500V Per minute.
  - Product number code:
 

DS1136-09 - X X X X

    - Housing color: W: White
    - Contact plating: N: Full nickel
    - Connector type: S: Socket
    - No. of contacts: 1440: 1440 Positions
    - SERIES No. DS1136-09

GENERAL TOLERANCE		ANGLE TOLERANCE		PROJECTION	TITLE	Bread Board pitch 2.54mm	
X.	±0.60	X.	±5°	mm			
.X	±0.38	.X	±3°	SHEET SIZE	A4	SERIES	DS1136-09 SERIES
.XX	±0.25	.XX	±2°	<b>晨翔电子有限公司</b> <b>CONNFLY ELECTRONIC CO. LTD</b>			
DRAWING TYPE		CUSTOMER					
SCALE		1:1					
DRAWING NO.		C-DS1136-09-XXXX		SHEET		1 OF 1	

REV.	DESCRIPTION	DRAWN	CHECKED	APPROVED
A	NEW RELEASE	LL 05/06/06'		

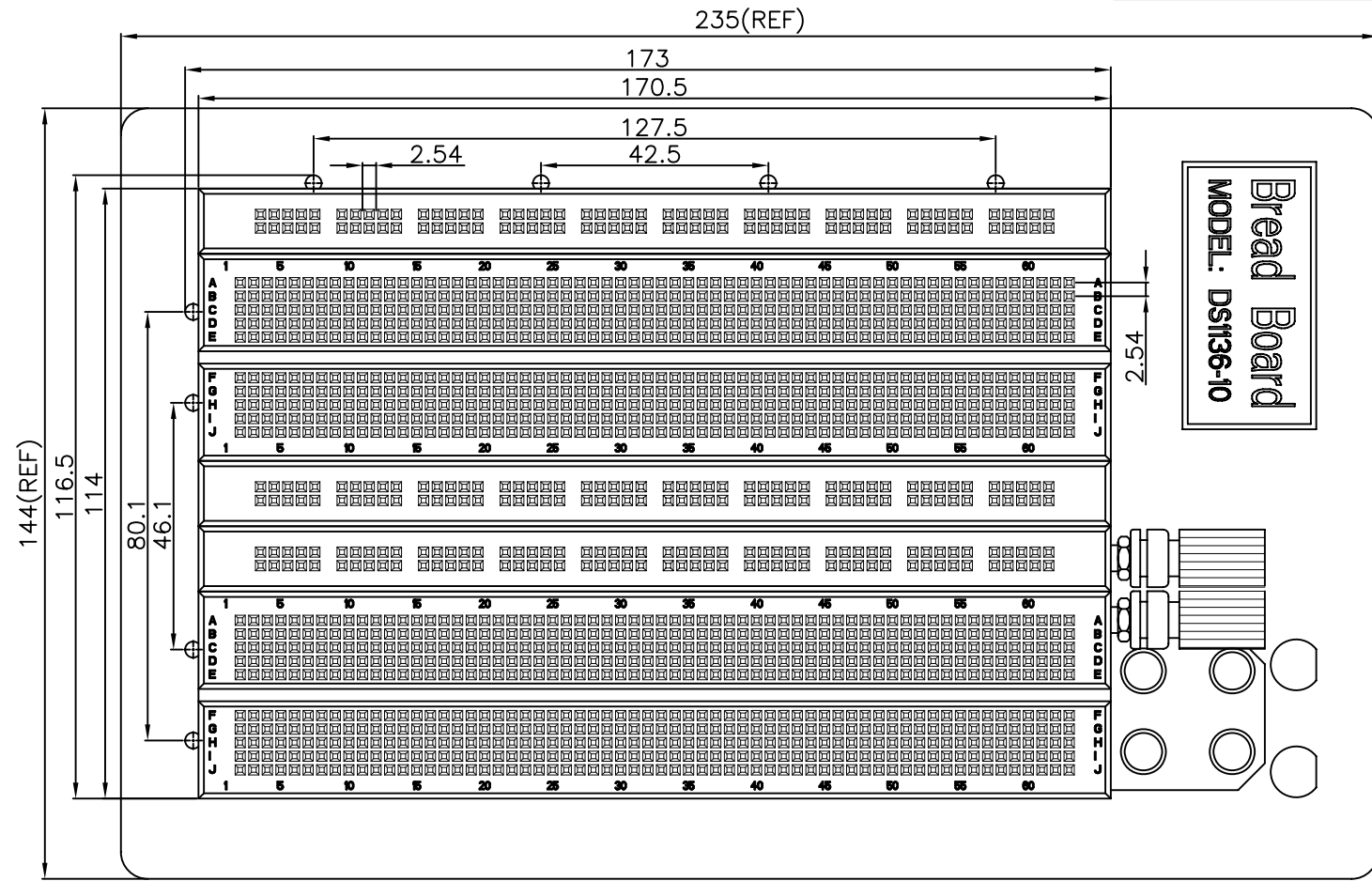

- NOTES:
- Materials
    - Insulator: thermoplastic
  - Specifications
    - Temperature range:  $-20\sim+80^{\circ}\text{C}$ .
    - Contact resistance:  $100\text{m}\Omega$  max.
    - Insulation resistance:  $1000\text{M}\Omega$  min. Per minute.
    - Dielectric withstanding voltage: AC 500V
  - Product number code:

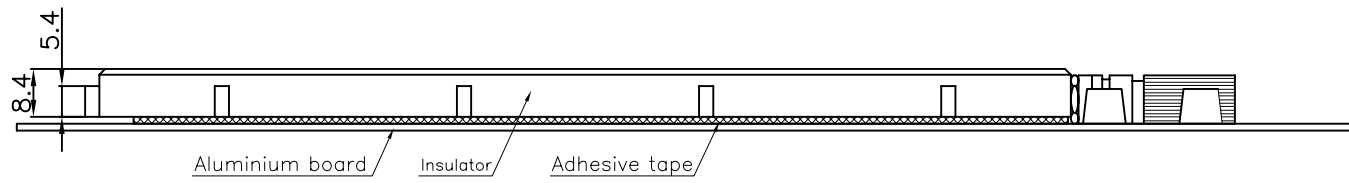
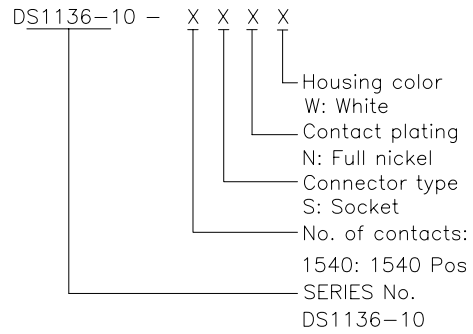

GENERAL TOLERANCE		ANGLE TOLERANCE		PROJECTION		TITLE	Bread Board pitch 2.54mm	
X.	$\pm 0.60$	X.	$\pm 5^{\circ}$	UNITS	mm			
.X	$\pm 0.38$	.X	$\pm 3^{\circ}$	SHEET SIZE	A4	SERIES	DS1136-10	SERIES
.XX	$\pm 0.25$	.XX	$\pm 2^{\circ}$	<b>晨翔电子有限公司</b> <b>CONNFLY CONNFLY ELECTRONIC CO. LTD</b>				
DRAWING TYPE		CUSTOMER						
SCALE		1:1	SHEET 1 OF 1					
DRAWING NO.		C-DS1136-10-XXXX						

REV.	DESCRIPTION	DRAWN	CHECKED	APPROVED
A	NEW RELEASE	LL 05/06/06'		

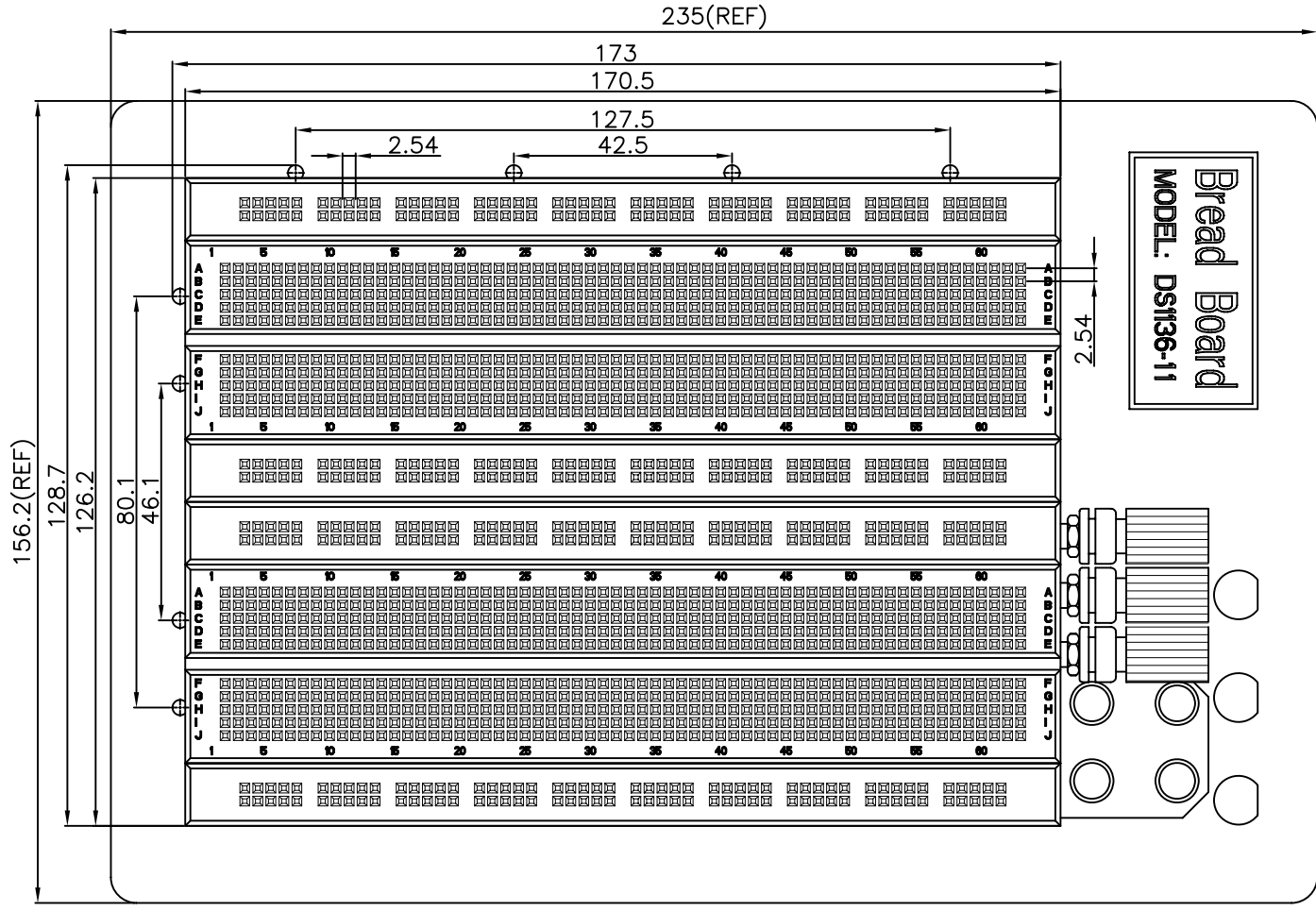

- NOTES:
- Materials
    - 1.1. Insulator: thermoplastic
  - Specifications
    - 2.1. Temperature range:  $-20\sim+80^{\circ}\text{C}$ .
    - 2.2. Contact resistance: 100mΩ max.
    - 2.3. Insulation resistance: 1000MΩ min.
    - 2.4. Dielectric withstanding voltage: AC 500V Per minute.
  - Product number code:
 

DS1136-11 - X X X X

    - Housing color: W: White
    - Contact plating: N: Full nickel
    - Connector type: S: Socket
    - No. of contacts: 1640: 1640 Position
    - SERIES No. DS1136-11

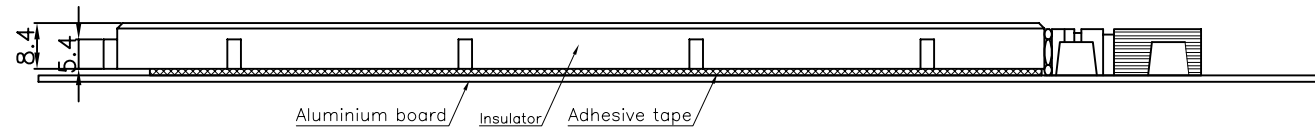

GENERAL TOLERANCE		ANGLE TOLERANCE		PROJECTION		TITLE	Bread Board pitch 2.54mm	
X.	±0.60	X.	±5°	UNITS	mm			
.X	±0.38	.X	±3°	SHEET SIZE	A4	SERIES	DS1136-11 SERIES	
.XX	±0.25	.XX	±2°	<b>晨翔电子有限公司</b> <b>CONNFLY CONNFLY ELECTRONIC CO. LTD</b>				
DRAWING TYPE		CUSTOMER						
SCALE		1:1	SHEET 1 OF 1					
DRAWING NO.		C-DS1136-11-XXXX						

REV.	DESCRIPTION	DRAWN	CHECKED	APPROVED
A	NEW RELEASE	LL 05/06/06'		

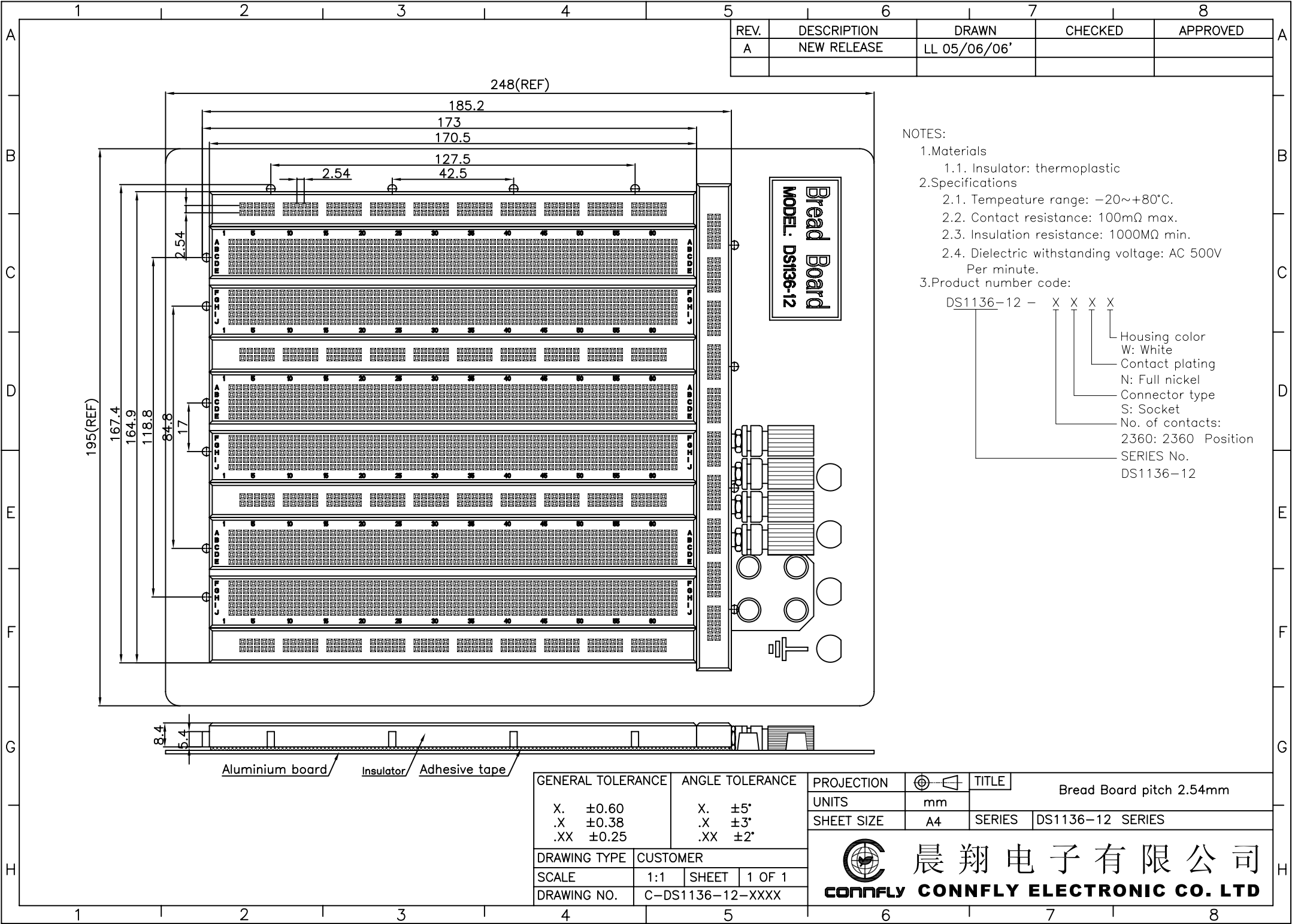

- NOTES:
- Materials
    - 1.1. Insulator: thermoplastic
  - Specifications
    - 2.1. Temperature range:  $-20\sim+80^{\circ}\text{C}$ .
    - 2.2. Contact resistance:  $100\text{m}\Omega$  max.
    - 2.3. Insulation resistance:  $1000\text{M}\Omega$  min.
    - 2.4. Dielectric withstanding voltage: AC 500V Per minute.
  - Product number code:
 

DS1136-12 - X X X X

    - X: Housing color (W: White)
    - X: Contact plating (N: Full nickel)
    - X: Connector type (S: Socket)
    - X: No. of contacts (2360: 2360 Position)

SERIES No. DS1136-12

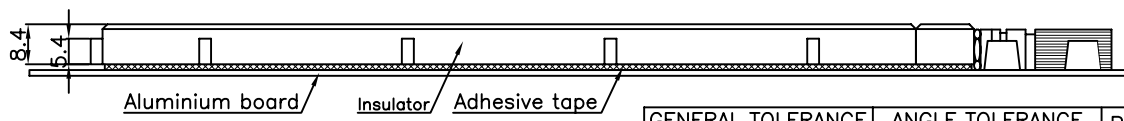

GENERAL TOLERANCE		ANGLE TOLERANCE		PROJECTION		TITLE	Bread Board pitch 2.54mm	
X.	$\pm 0.60$	X.	$\pm 5^{\circ}$	UNITS	mm			
.X	$\pm 0.38$	.X	$\pm 3^{\circ}$	SHEET SIZE	A4	SERIES	DS1136-12	SERIES
.XX	$\pm 0.25$	.XX	$\pm 2^{\circ}$	<b>晨翔电子有限公司</b> <b>CONNFLY CONNFLY ELECTRONIC CO. LTD</b>				
DRAWING TYPE		CUSTOMER						
SCALE		1:1						
DRAWING NO.		C-DS1136-12-XXXX						

REV.	DESCRIPTION	DRAWN	CHECKED	APPROVED
A	NEW RELEASE	LL 05/06/06'		

NOTES:

1. Materials
  - 1.1. Insulator: thermoplastic
2. Specifications
  - 2.1. Temperature range: -20~+80°C.
  - 2.2. Contact resistance: 100mΩ max.
  - 2.3. Insulation resistance: 1000MΩ min.
  - 2.4. Dielectric withstanding voltage: AC 500V  
Per minute.
3. Product number code:

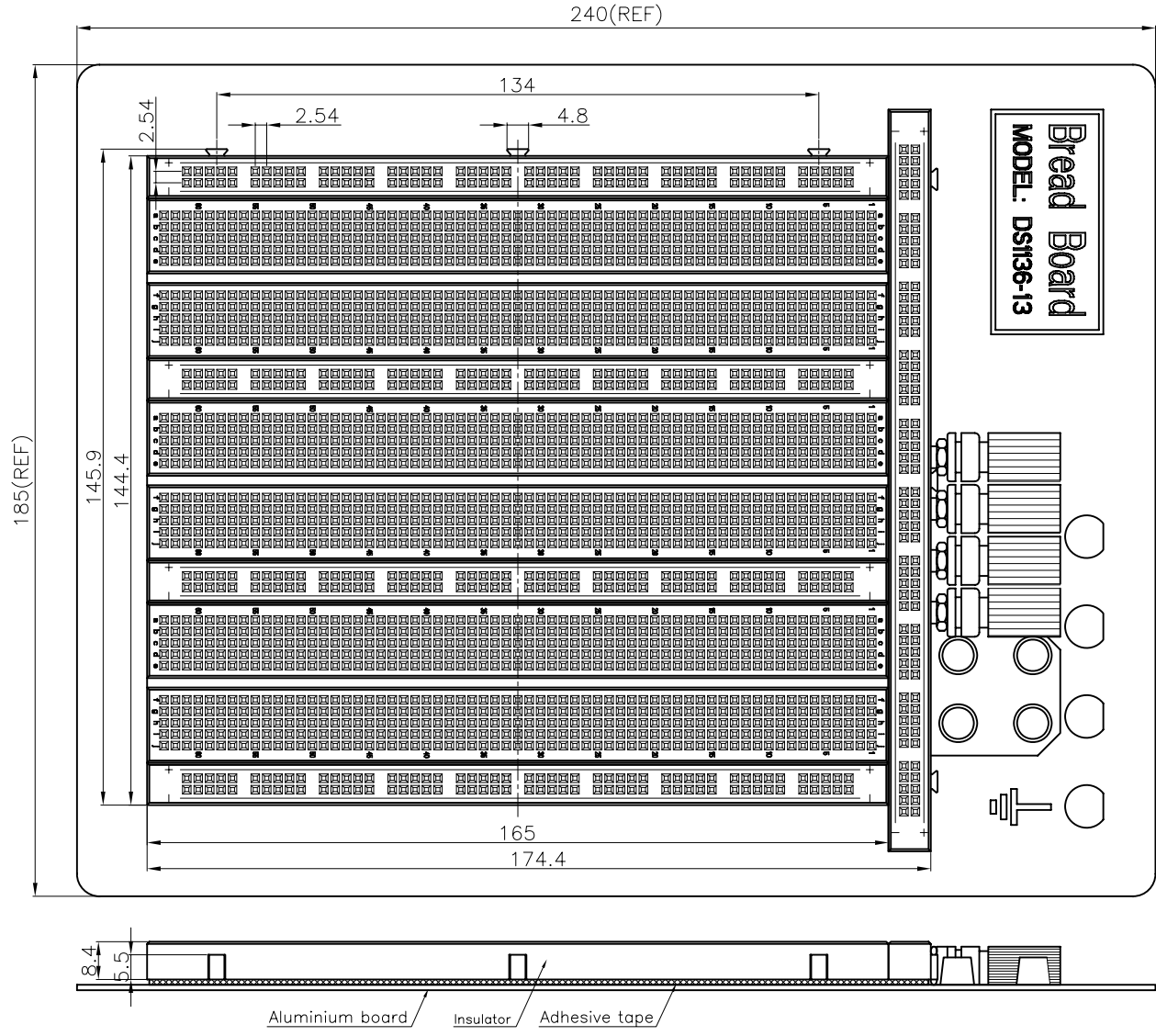
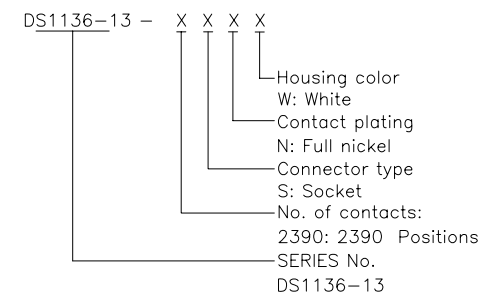

GENERAL TOLERANCE		ANGLE TOLERANCE		PROJECTION		TITLE	
X.	±0.60	X.	±5°	UNITS	mm	Bread Board pitch 2.54mm	
.X	±0.38	.X	±3°	SHEET SIZE	A4	SERIES	DS1136-13 SERIES
.XX	±0.25	.XX	±2°	<b>晨翔电子有限公司</b> <b>CONFLY CONFLY ELECTRONIC CO. LTD</b>			
DRAWING TYPE		CUSTOMER					
SCALE		1:1 SHEET 1 OF 1					
DRAWING NO.		C-DS1136-13-XXXX					

REV.	DESCRIPTION	DRAWN	CHECKED	APPROVED
A	NEW RELEASE	LL 05/06/06'		

NOTES:

1. Materials
  - 1.1. Insulator: thermoplastic
2. Specifications
  - 2.1. Temperature range: -20~+80°C.
  - 2.2. Contact resistance: 100mΩ max.
  - 2.3. Insulation resistance: 1000MΩ min.
  - 2.4. Dielectric withstanding voltage: AC 500V Per minute.

3. Product number code:

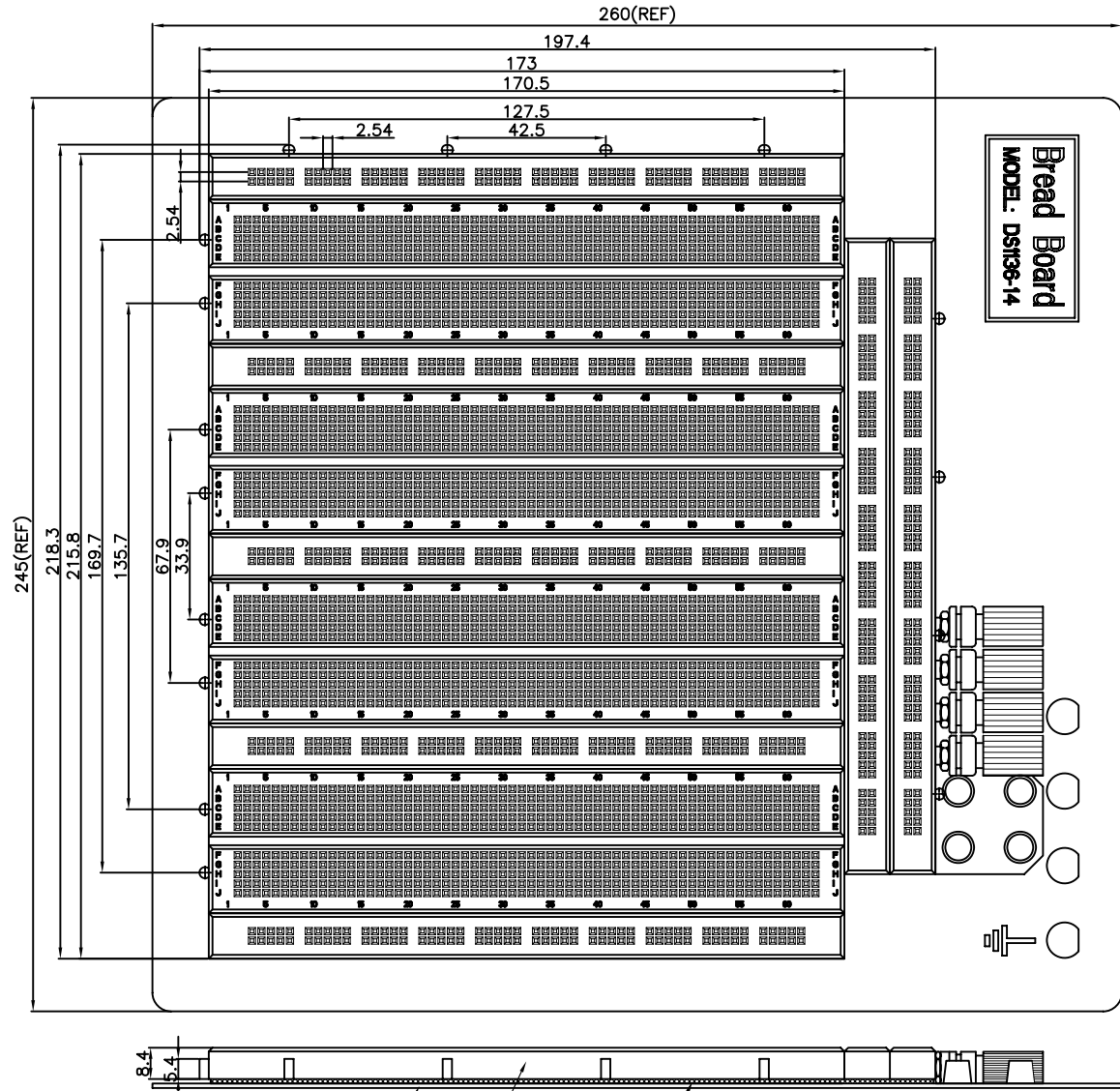
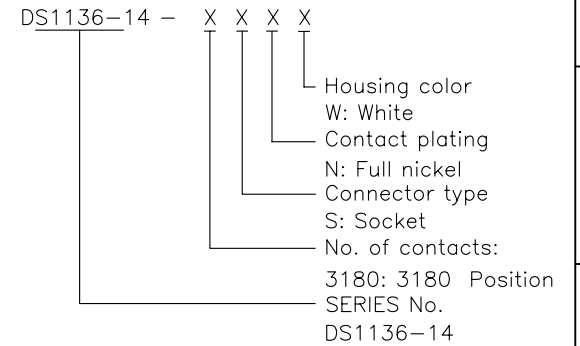

GENERAL TOLERANCE	ANGLE TOLERANCE
X. ±0.60	X. ±5°
.X ±0.38	.X ±3°
.XX ±0.25	.XX ±2°

PROJECTION	TITLE
UNITS	Bread Board pitch 2.54mm
SHEET SIZE	SERIES DS1136-14 SERIES

DRAWING TYPE	CUSTOMER
SCALE	1:1 SHEET 1 OF 1
DRAWING NO.	C-DS1136-14-XXXX

**晨翔电子有限公司**  
**CONNFLY ELECTRONIC CO. LTD**

REV.	DESCRIPTION	DRAWN	CHECKED	APPROVED
A	NEW RELEASE	LL 05/06/06'		

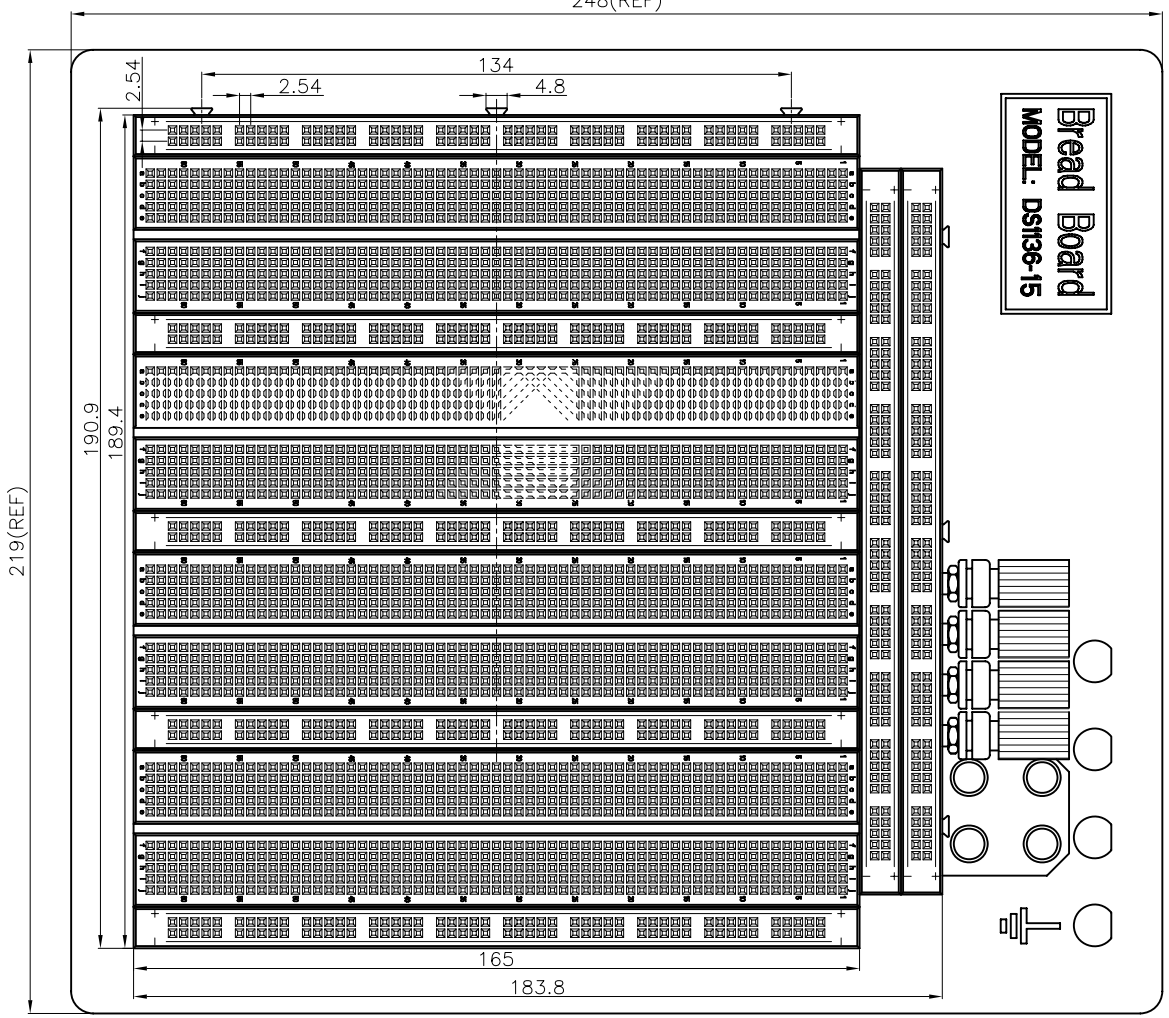

- NOTES:
- Materials
    - 1.1. Insulator: thermoplastic
  - Specifications
    - 2.1. Temperature range:  $-20\sim+80^{\circ}\text{C}$ .
    - 2.2. Contact resistance:  $100\text{m}\Omega$  max.
    - 2.3. Insulation resistance:  $1000\text{M}\Omega$  min.
    - 2.4. Dielectric withstanding voltage: AC 500V Per minute.
  - Product number code:
 

DS1136-15 - X X X X

    - Housing color
    - W: White
    - Contact plating
    - N: Full nickel
    - Connector type
    - S: Socket
    - No. of contacts: 3220: 3220 Positions
    - SERIES No. DS1136-15

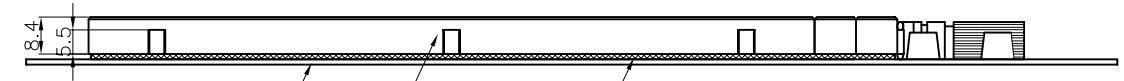

Aluminium board Insulator Adhesive tape

GENERAL TOLERANCE	ANGLE TOLERANCE
X. $\pm 0.60$	X. $\pm 5^{\circ}$
.X $\pm 0.38$	.X $\pm 3^{\circ}$
.XX $\pm 0.25$	.XX $\pm 2^{\circ}$

PROJECTION	TITLE
UNITS	mm
SHEET SIZE	A4
SERIES	DS1136-15 SERIES

DRAWING TYPE	CUSTOMER
SCALE	1:1 SHEET 1 OF 1
DRAWING NO.	C-DS1136-15-XXXX

**晨翔电子有限公司**  
**CONNFLY CONNFLY ELECTRONIC CO. LTD**

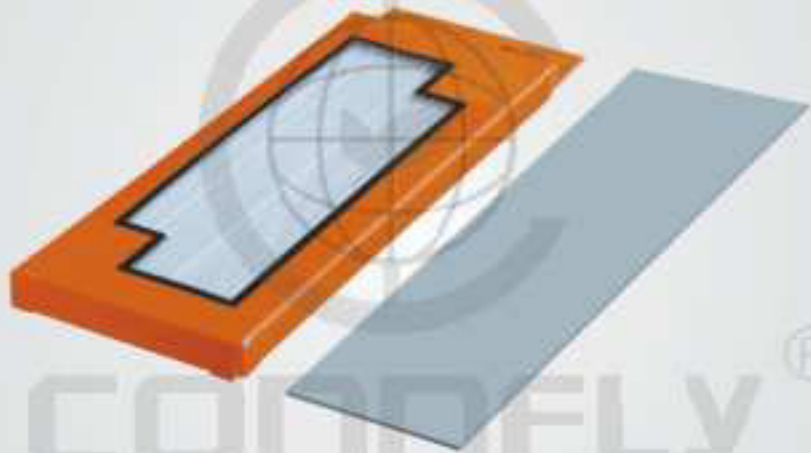

COMINFLY<sup>®</sup>



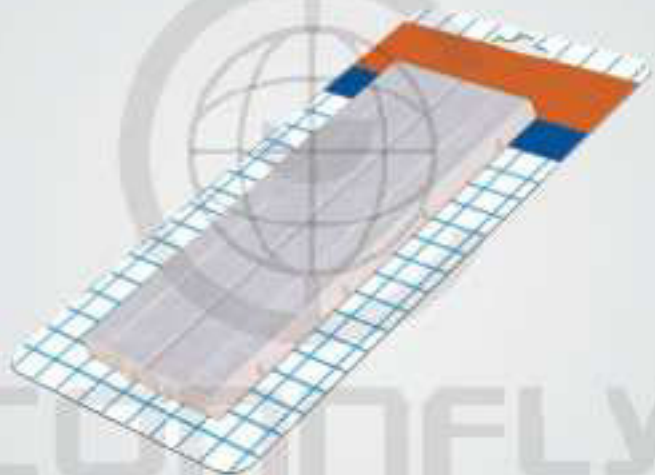

®

COMINFLY

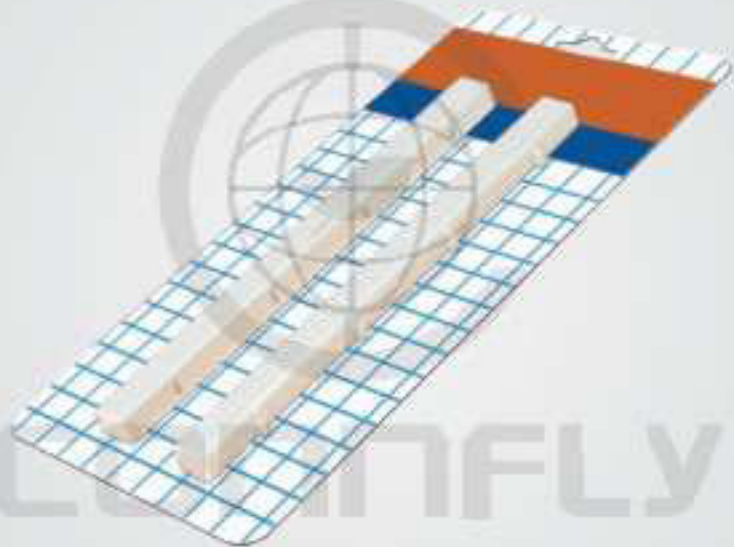

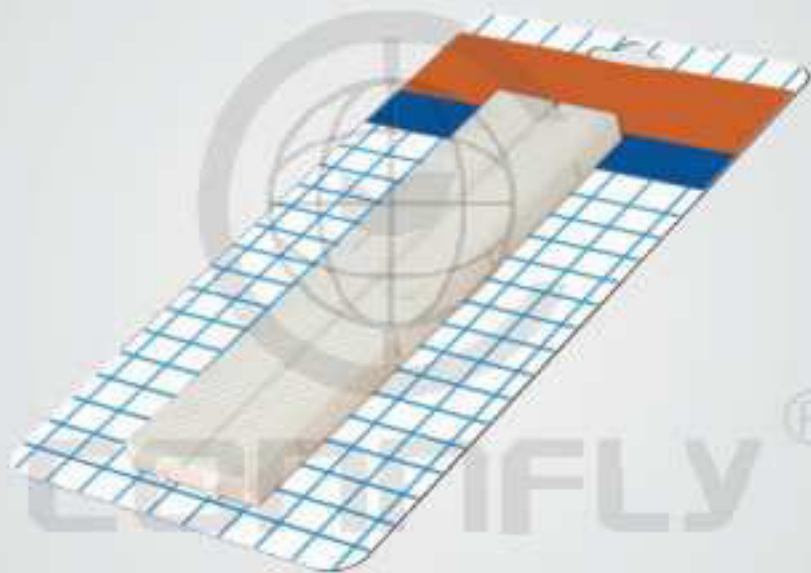

®

E-FLY

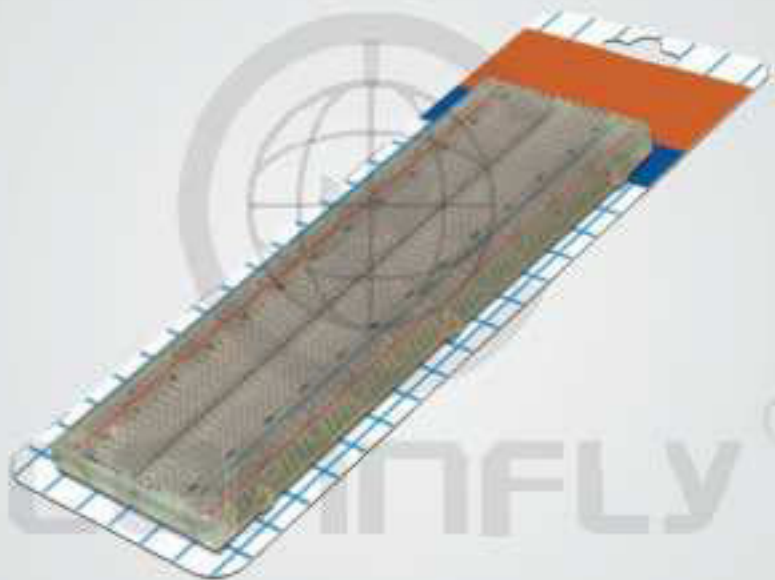

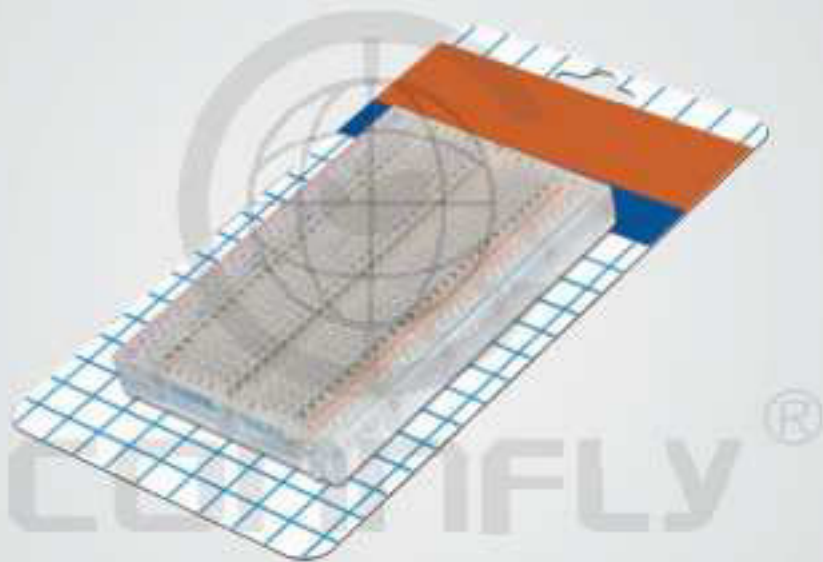

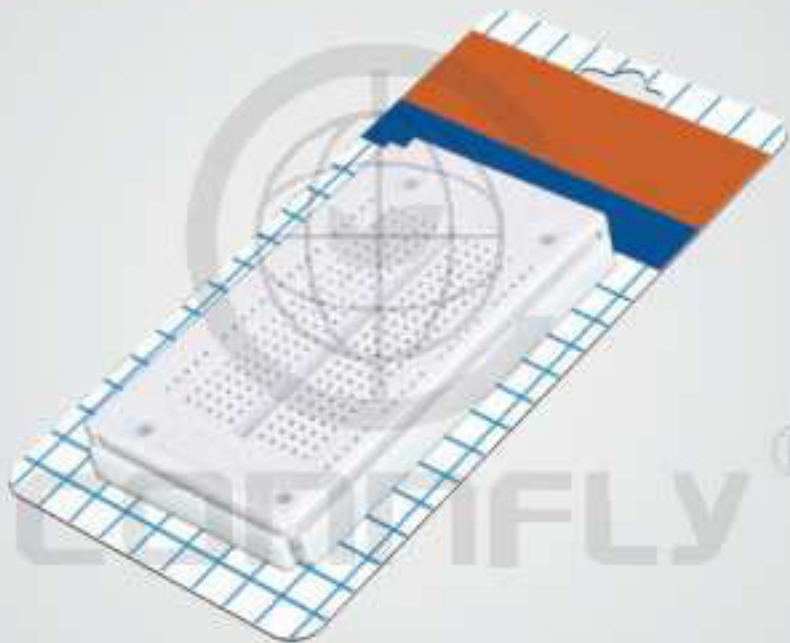

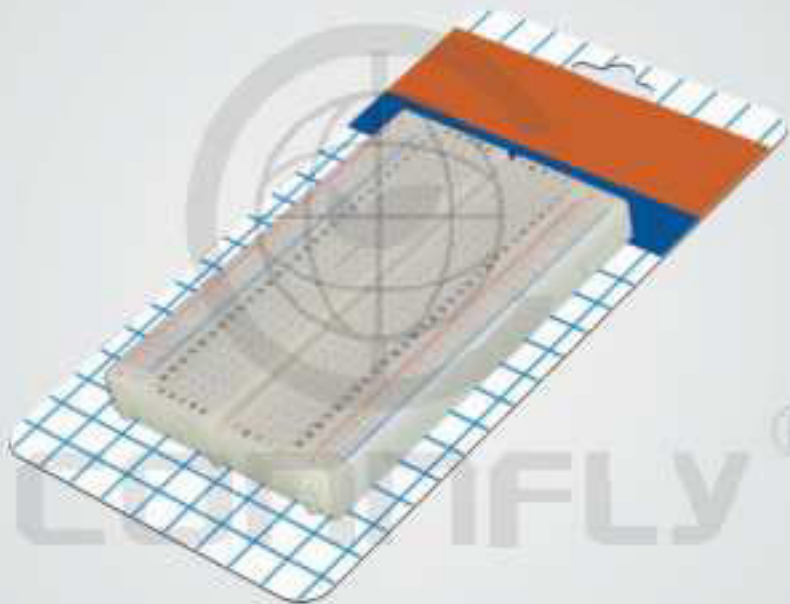

FLY®

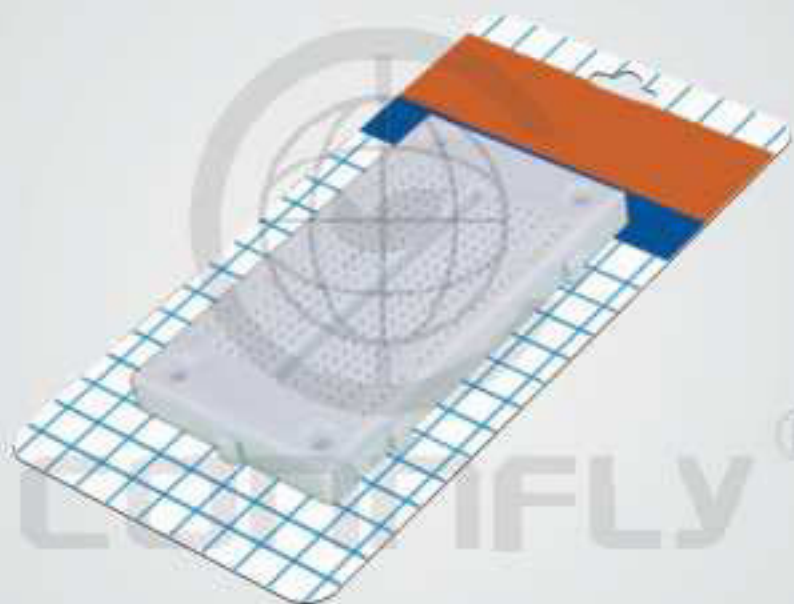

®

IFLY



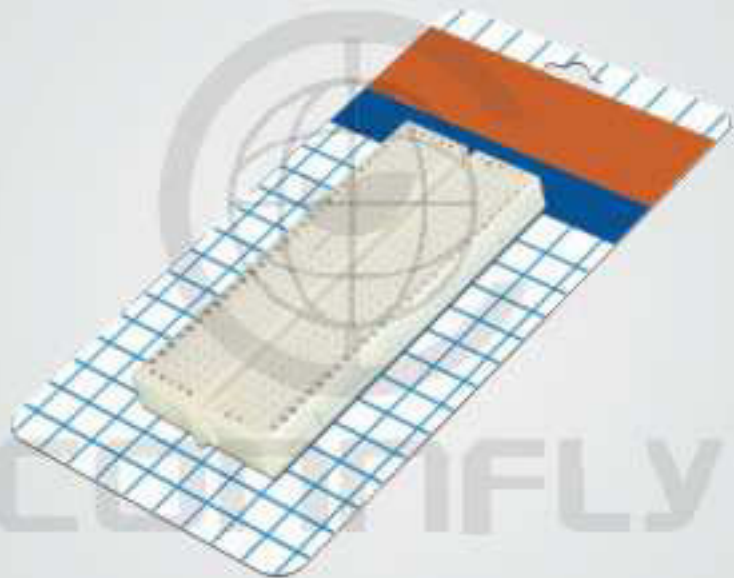



CONNFLY®

